

RACCORDS THERMOPLASTIQUES

Raccords en Polypropylène

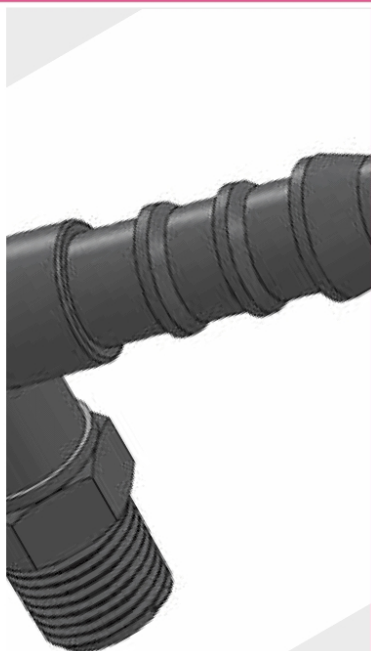

+4°C ÷ +90°C
Subject to applications



Up to 14 Bar at 20°C



Compressed air, water and fluids
suitable with construction materials



Taper gas BSPT ISO 7
from R1/8" to R1"
Parallel gas BSPP ISO 228
from G1/8" to G1"



To be used only for connecting LDPE
Agricultural tubes Class 2.5 and
Class 4 and other flexible tubes



Polypropylene

FEATURES

Good resistance to chemicals

PRECAUTIONS

- The products are made in plastic and it's necessary to use teflon tape over the thread for installation in order and to prevent air leakage. Be sure to prevent excessive torque when screwing the fittings.
- To connect the tube, insert the tube to the end and tight the cap before use.
- Cut the pressed part of the tube before connection to reuse the released tube



Products in compliance with
the directive 2002/95/EC

RoHS2

Products in compliance with
the directive 2011/65/EU

DIAMETER OF THE BARB

O.D. EXTERNAL TUBE	Ø12	Ø16	Ø20	Ø25
ØB - barb	11.9 mm	15.8 mm	19.0 mm	23.0 mm



I.D. INTERNAL TUBE	Ø6	Ø8	Ø10	Ø12	Ø14	Ø16	Ø19
ØB - barb	8.1	10.2	12.4	13.9	15.9	18.1	21.0
ØD	6.1	8.1	10.1	11.9	13.8	15.9	18.8



Only for code 5570

YIELD STRESS OF PP AS A FUNCTION OF TEMPERATURE

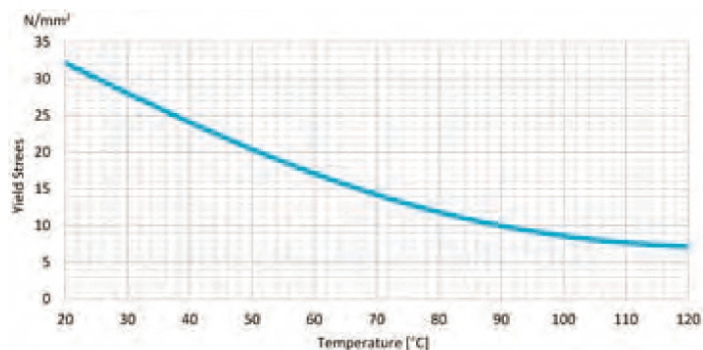

RECOMMENDED TIGHTENING TORQUE

THREAD SIZE	NM	FT LB
1/8	0,01	0,01
1/4	0,3	0,2
3/8	1	1
1/2	2	2
3/4	5	4
1	8	6