

HEAT TRANSFER DIMPLE JACKET

Stainless Steel Fabrication Services.



Precision dimple jackets for your DIY tank fabrications!

FABRICATION OPTIONS

We provide dimple in the flat or rolled. Radial or straight patterns are available with your specified cutouts for attaching to shells, dished & flat heads, and cone sections.

SIMPLE INSTALLATION

We make dimple installation easy. Your fabrications will be formed to fit exact dimensional requirements, with crimped edges for easier welding and fitup!

ASME CERTIFIED COMPONENTS

CMPI can provide fully welded dimple fabrications with an ASME CODE stamp. Proof test panels are available upon request, per ASME standards.

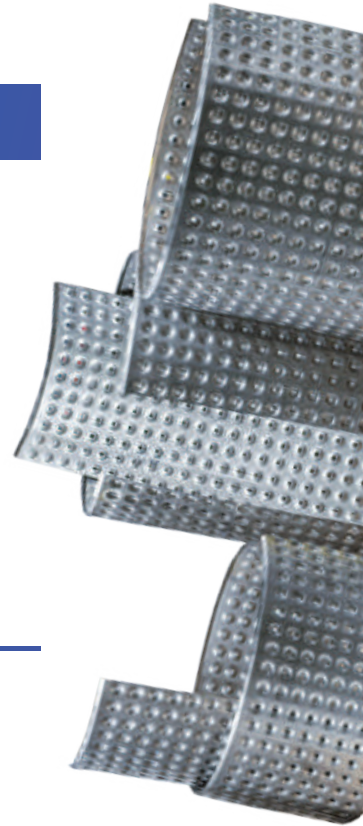

DIMPLE JACKET SPECIFICATIONS

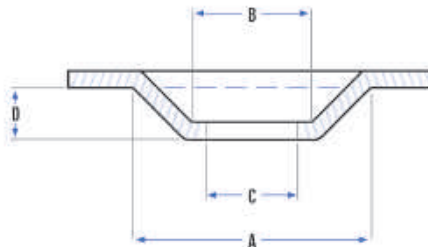

Style	Gauges	A	B	C	D	Min. Spacing Straight	Min. Spacing Radial
1	16, 14, 12	1.40	0.75	0.438	0.20	1.70	2.00
3	16, 14, 12	1.40	0.81	0.500	0.24	1.65	2.00
4	16, 14	1.40	0.89	0.375	0.22	1.70	2.00
7	14, 12	1.47	0.75	0.568	0.28	1.85	2.13
9	14, 12, 11, 10	1.84	1.00	0.625	0.33	2.44 on 48 Wide 3.00 on 60 Wide	2.75
10	16, 14, 12	1.40	1.03	0.625	0.25	1.70	2.00
11	11, 10	1.40	0.81	0.500	0.24	1.70	2.00
12	11, 12	1.84	1.06	0.305	0.33	2.44 on 48 Wide 3.00 on 60 Wide	2.75



Custom Mfg. & Polishing, Inc.

We Help You **Define Brilliance.**

2958 E. Division St.
Springfield, MO 65803

Phone: 417.831.7900
Fax: 417.831.4285

www.cmpionline.com
Email: sales@cmpionline.com