



# CAMDEN COLLECTION

RIVERSIDE, CA

---

*Opening Doors to  
Better Communities*



[rchobbs.com/camden-collection](http://rchobbs.com/camden-collection) | 951.336.1070



## *Welcome to Camden*

---

Camden Collection is a limited collection of only 34 single-family, two-story homes, located in the heart of Riverside—close to shopping, entertainment, and more! Enjoy private onsite amenities including a walking trail with exercise equipment and a relaxing park area with benches. As a part of one of the fastest growing metropolis areas in the Inland Empire, Riverside offers its residents a desirable place to live, work, and play!

With its central location and close proximity to the freeway as well as the Metrolink Station, Camden Collection provides a great alternative for commuters who work in the LA area who prefer to live in a more peaceful neighborhood. Residents also have a variety of options when it comes to recreation with only a short drive to the mountains in one direction and the beaches of Orange County in the other. With its rich history as well as the many community parks and facilities, Riverside makes for the perfect new home community!

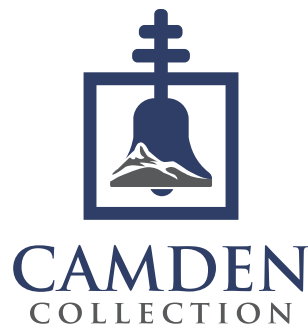

## FEATURES

### TECHNOLOGY & ENERGY

- ✦ Energy efficient Low-E vinyl windows and insulated entry doors
- ✦ Economical, thermostatically controlled, gas forced-air heating with pilotless ignition
- ✦ 13 SEER air conditioning with energy-efficient programmable thermostat
- ✦ Water conserving, low flush toilets
- ✦ Water conserving bath and shower heads
- ✦ High velocity ventilation fan in primary bath
- ✦ Energy-saving weather-stripping on all exterior doors and interior doors leading to the garage
- ✦ 200 amp service panel
- ✦ Safety-conscious fire sprinkler system with smoke detectors and carbon monoxide sensor
- ✦ Standard tankless water heater
- ✦ Ask us about our available solar program

### QUALITY CONSTRUCTION

RC Hobbs Company, Inc. is committed to earning the trust of our homeowners by delivering a structurally and architecturally well-built house. Our homeowner's will have peace of mind knowing their houses were built with:

- ✦ Fire-resistant, concrete tile roof with a limited lifetime warranty
- ✦ Weatherproofing systems at windows and exterior wall penetrations that exceed traditional building standards
- ✦ Engineered wood flooring systems providing exceptional strength and performance

### THE RC HOBBS EXPERIENCE

- ✦ A high-performance home engineered for energy efficiency, cost savings and comfort
- ✦ One-year RC Hobbs homes limited warranty
- ✦ Design Studio with options available to personalize your new home

### EXTERIOR FEATURES

First impressions make all the difference! The following exterior features have been carefully selected to provide each RC Hobbs home with its own sense of "curb appeal."

- ✦ Architectural styling showcasing Spanish, French, and Cottage designs
- ✦ Raised panel insulated entry door
- ✦ Spacious attached two car garages with direct home access
- ✦ Sectional roll-up garage door with automatic opener
- ✦ Fully finished drywalled garages
- ✦ Service door with concrete stoop
- ✦ Front yard landscaping including automatic irrigation system and rain sensor
- ✦ Front porch/courtyard (per plan)

### INTERIOR FEATURES

Spacious rooms and elegant features help make a house a home. Features that make RC Hobbs homes special are:

- ✦ Nine-foot high ceilings at first floor
- ✦ Rounded bullnose corners throughout
- ✦ Ceramic tile entries with vinyl flooring in kitchen, baths, and laundry
- ✦ Spacious linen storage (per plan)
- ✦ Interior laundry room
- ✦ Natural gas stub for dryer
- ✦ Cheyenne style interior doors
- ✦ Cat 6 telephone outlet in all rooms
- ✦ TV/Data outlet in great rooms and loft/flex space areas
- ✦ Low Volatile Organic Compounds (VOC) paints and carpets for better indoor air quality
- ✦ Great room and primary bedroom prewired for optional ceiling fan

### KITCHEN APPLIANCES

RC Hobbs homes are designed with spacious kitchens to serve your family and entertain your guests. The kitchen is the focal point of many homes, and your kitchen has been designed to include:

- ✦ Whirlpool® stainless steel appliance package, including:
- ✦ 30" gas (range)
- ✦ Multi-cycle Energy Star® dishwasher
- ✦ Microwave oven with vented hood
- ✦ Food preparation and eat-in island (per plan)
- ✦ Single basin stainless steel sink, with chrome pull-out faucet
- ✦ Granite slab countertops with 6" backsplash
- ✦ Pre-plumbed for refrigerator icemaker
- ✦ High-efficiency LED ceiling lighting throughout
- ✦ Insinkerator® disposal

### PRIMARY SUITE

The primary bedroom and bath have been designed with a perspective that goes beyond conventional floor plans to created a private suite that includes:

- ✦ Adult-height vanities
- ✦ Luxurious soaking tub and shower combo (per plan)
- ✦ Quality sparkling Peerless® chrome faucets
- ✦ Durable E-stone countertops
- ✦ Spacious walk-in closet with shelf and pole
- ✦ His and Hers walk-in closets (per plan)



Elevation A - Spanish



Elevation B - French



Elevation C - Cottage





## RESIDENCE ONE

- + Attractive two story home + 1,864 sq. ft. of living space + Three bedrooms, two and one-half baths + Loft/flex space
- + Contemporary kitchen with granite countertops + Upstairs laundry room + Porch + Two-car attached garage

ELEVATION B

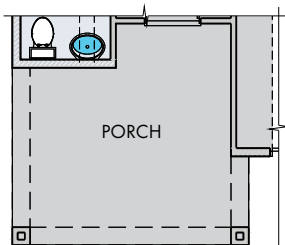

ELEVATION C

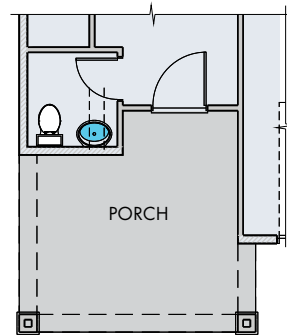

LOWER FLOOR

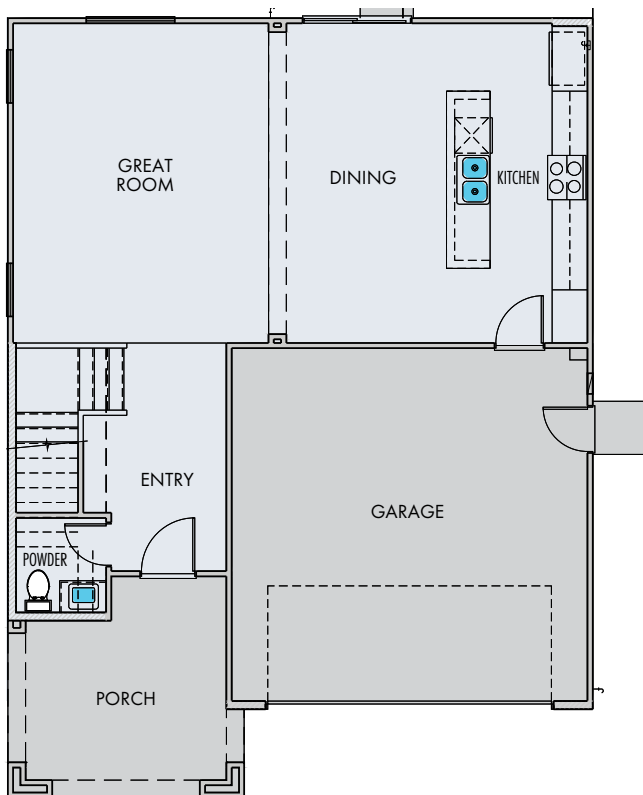

UPPER FLOOR

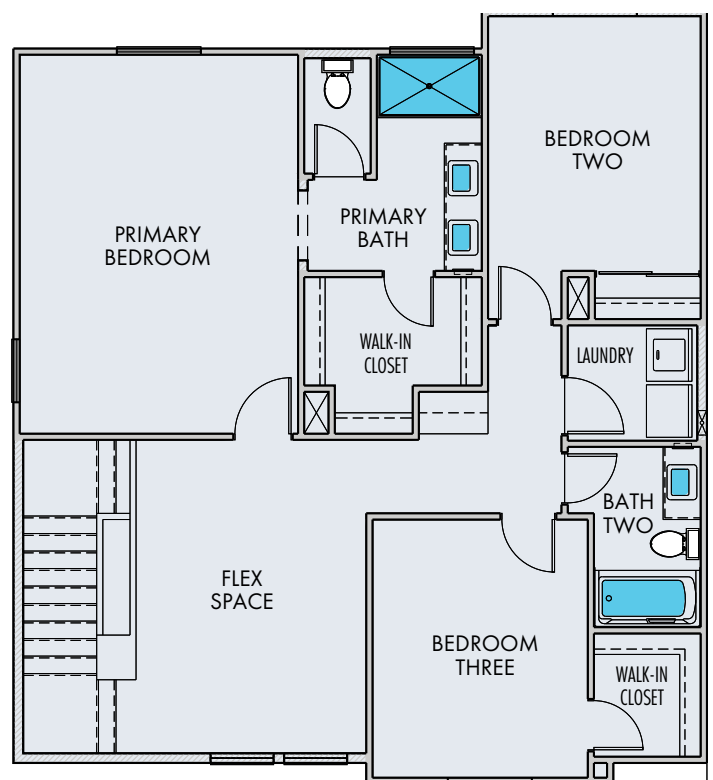



Elevation A - Spanish



Elevation B - French



Elevation C - Cottage





## RESIDENCE TWO

- + Attractive two story home + 2,100 sq. ft. of living space + Four bedrooms, three bathrooms + Loft/flex space
- + Contemporary kitchen with granite countertops + Upstairs laundry room + Porch/courtyard
- + Two-car attached garage

LOWER FLOOR

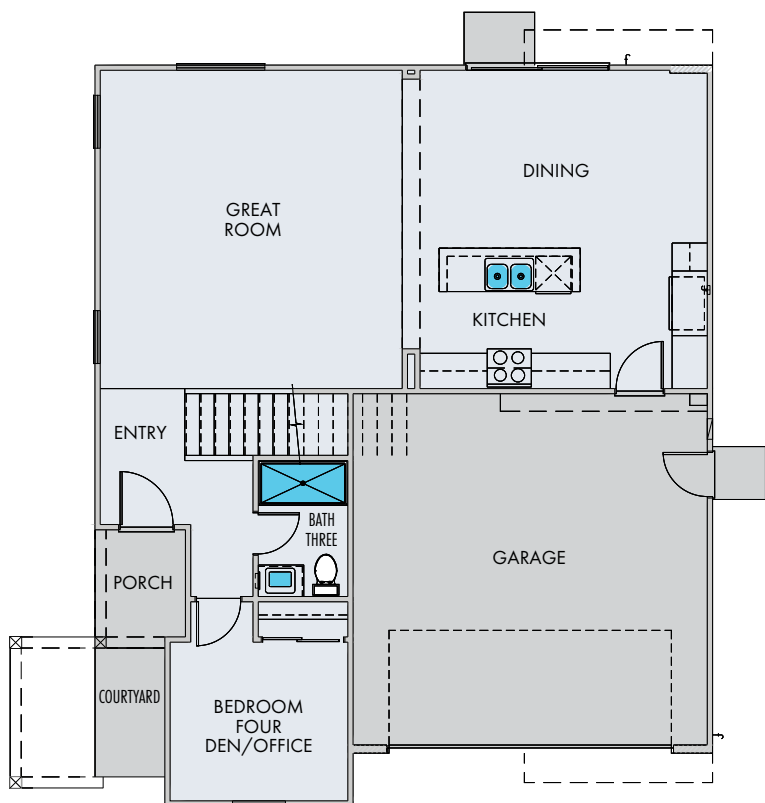

UPPER FLOOR

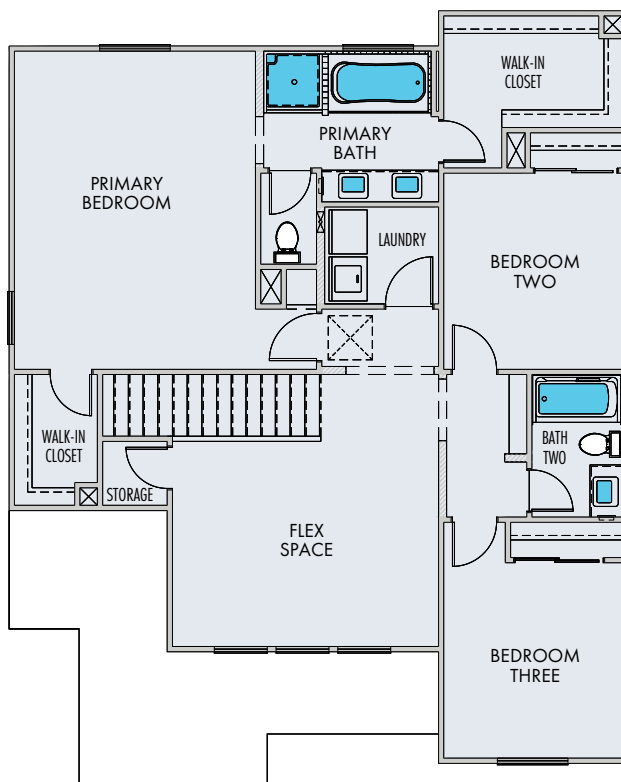

Elevation A - Spanish



Elevation B - French



Elevation C - Cottage





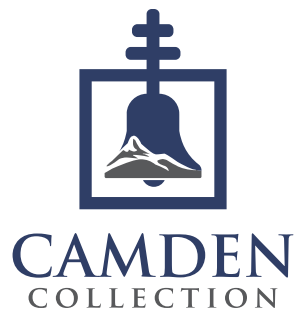

## RESIDENCE THREE

- + Attractive two story home + 2,482 sq. ft. of living space + Five bedrooms, three bathrooms + Loft/flex space
- + Contemporary kitchen with granite countertops + Upstairs laundry room + Porch + Two-car attached garage

### LOWER FLOOR

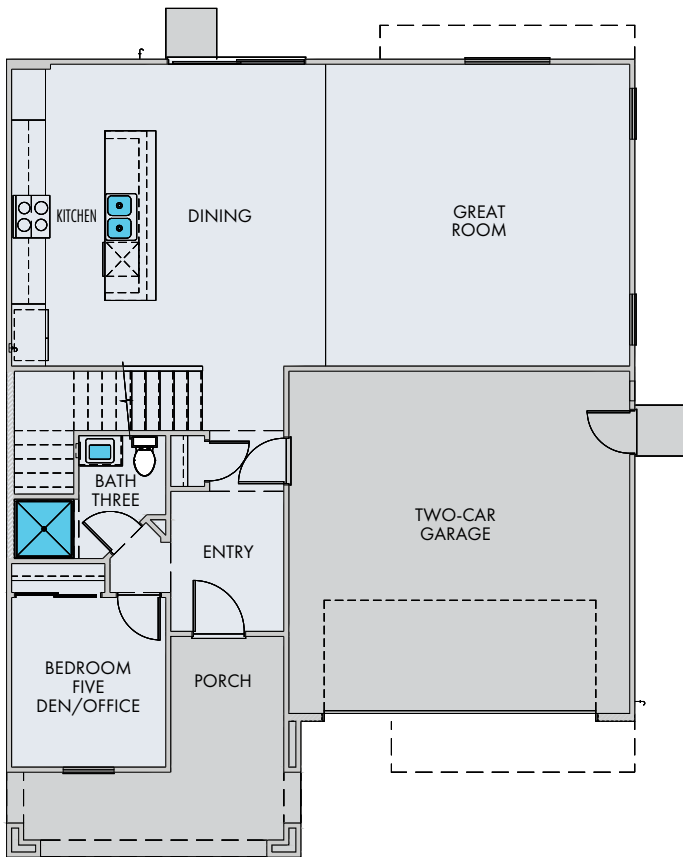

### UPPER FLOOR

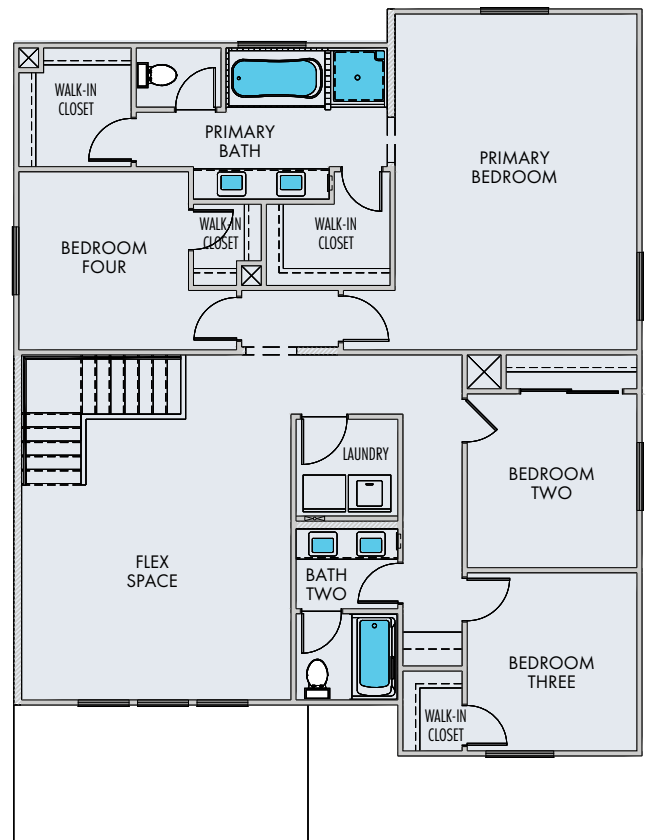



**RC HOBBS**  
C O M P A N I E S

For over 40 years the RC Hobbs Family of Companies has built innovative, award-winning new home communities throughout Southern California. To date, RC Hobbs has built more than 4,500 homes and is well-recognized as an industry leader and innovator.

Today, the RC Hobbs Company is a full-service real estate organization that maintains expertise in both for sale and for rent single-family and multi-family housing as well as commercial investment properties.

We build for you! RC Hobbs is dedicated to providing high-quality homes of exceptional value. Our communities are uniquely designed and amenitized to meet the needs of our residents and are located in desirable locations in close proximity to shopping, dining, and employment centers.

We are a family owned and operated company that values honesty and integrity. The company's success is a product of dynamic and responsible leadership consisting of a team approach, whereby each team member's talent, expertise, and experience are applied toward attaining meaningful results.

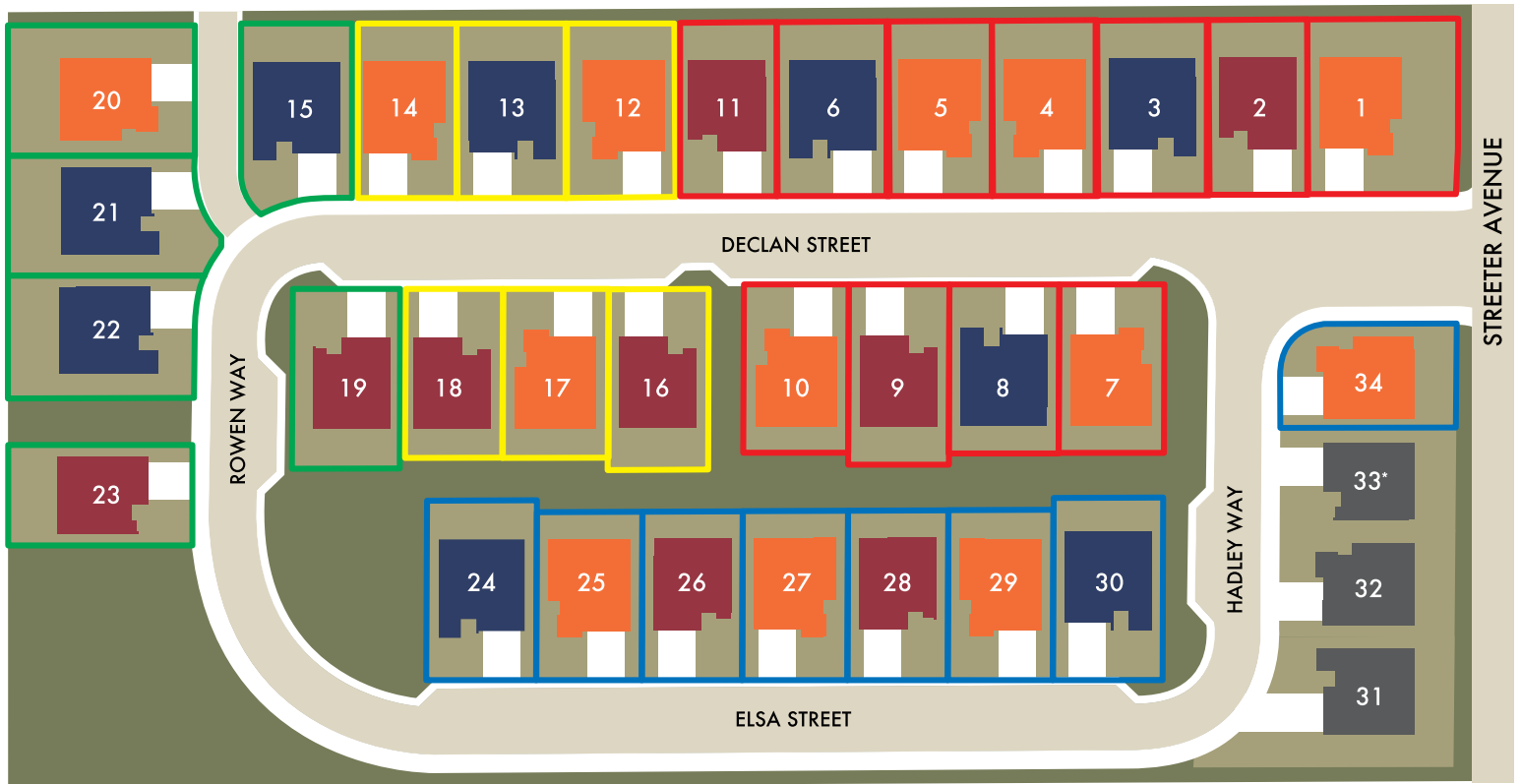

- MODELS
- RESIDENCE ONE
- RESIDENCE TWO
- RESIDENCE THREE
- PHASE ONE
- PHASE TWO
- PHASE THREE
- PHASE FOUR

Map is conceptual only and is not to scale. Actual development, including any planned features, may vary from map and may be outside the control of RC Hobbs. ©2020 RC Hobbs. DRE #00401619





# CAMDEN COLLECTION

RIVERSIDE, CA

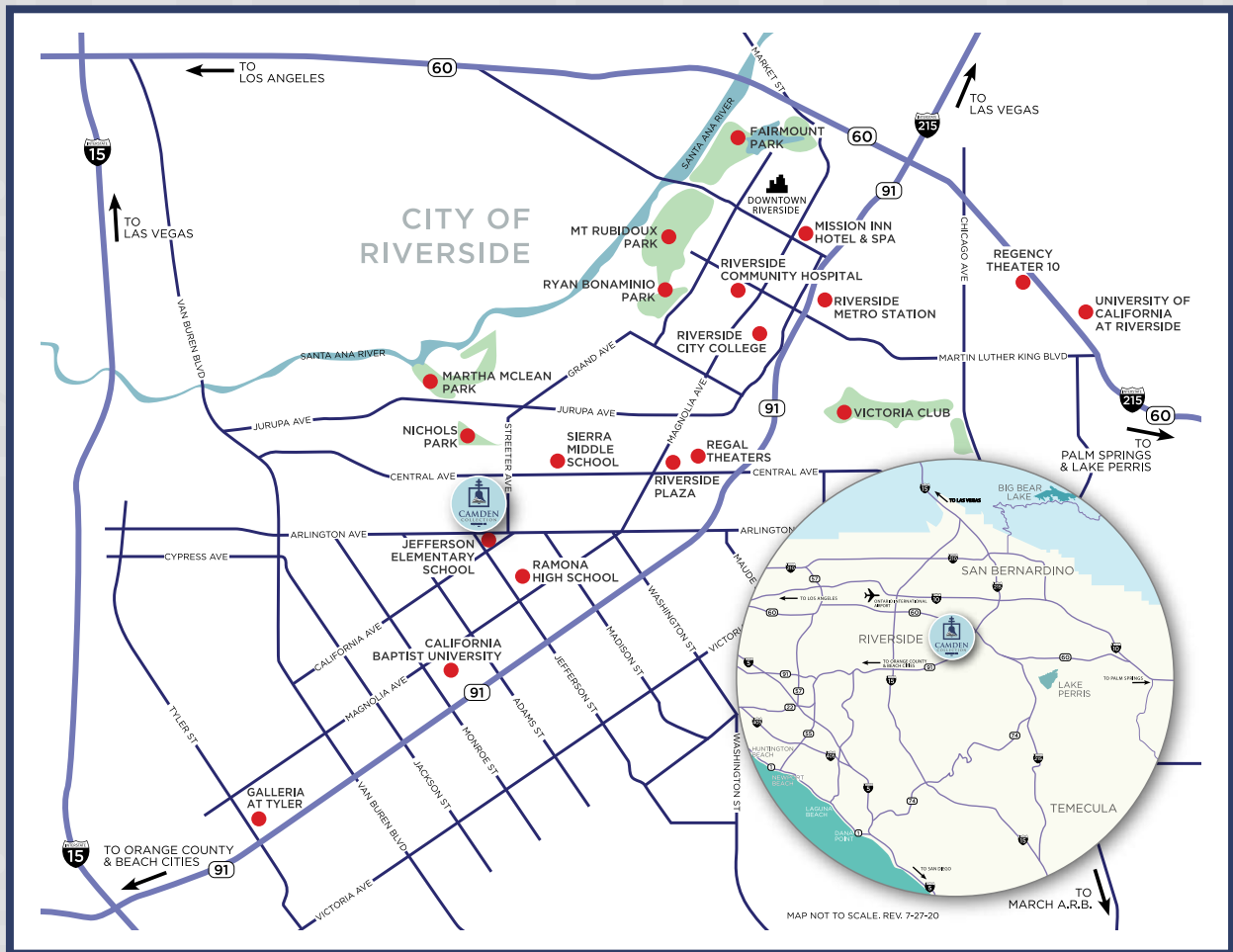

6789 Streeter Ave.  
Riverside, CA 92504

[rchobbs.com/camden-collection](http://rchobbs.com/camden-collection) | 951.336.1070