

SETTING OUT A BUILDING

Reference: Building a House: Framing Practice (pages 6 – 17)

ASSESSMENT 1: HURDLES/BUILDING PROFILES

How: Read pages 11 – 12 of Building a House: Framing Practice, then identify and explain each hurdle/profile type in the space provided below.

Type of hurdle/profile

.....
.....
.....
.....
.....

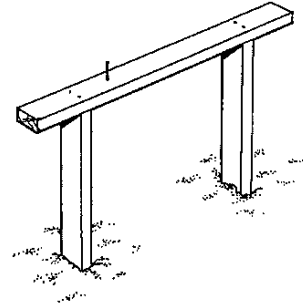

.....

Type of hurdle/profile

.....
.....
.....
.....
.....

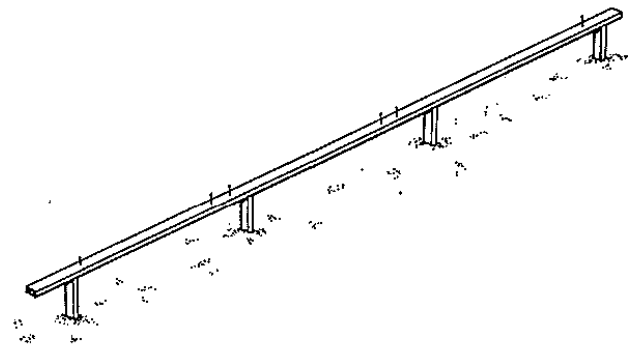

.....

Type of hurdle/profile

.....
.....
.....
.....
.....
.....
.....
.....

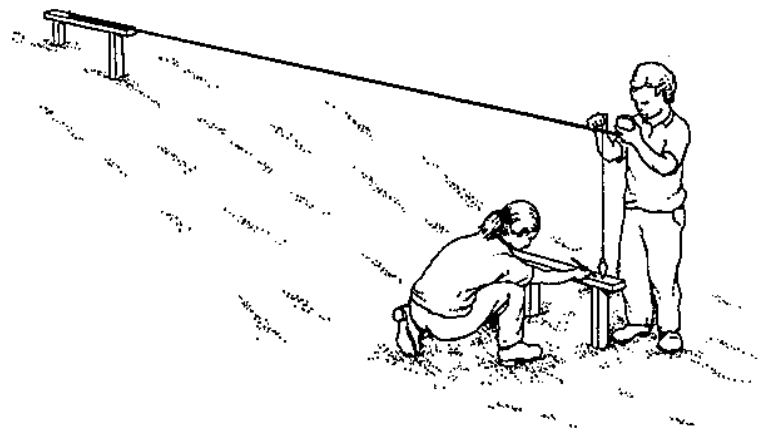

.....

But how do we get it square?

Reference: Building a House: Framing Practice (pages 5 – 17)

Setting out the building square is probably the most challenging bit and the area open to greatest error. Taking your time, using Phythagoras’s 3 – 4 – 5 rule and measuring the diagonals (each diagonal should be equal) will help here.

Setting out a building

There are many different ways to set out a building on its site. We will be using the process best described in Building a house: Framing practice pages 6 – 17. It is a well written book with simple steps to follow and I know it works. Let’s try it. I’m sure at the end of the tasks you will agree.

We will set out the ‘L’ shaped house plan on the right, on a building site.

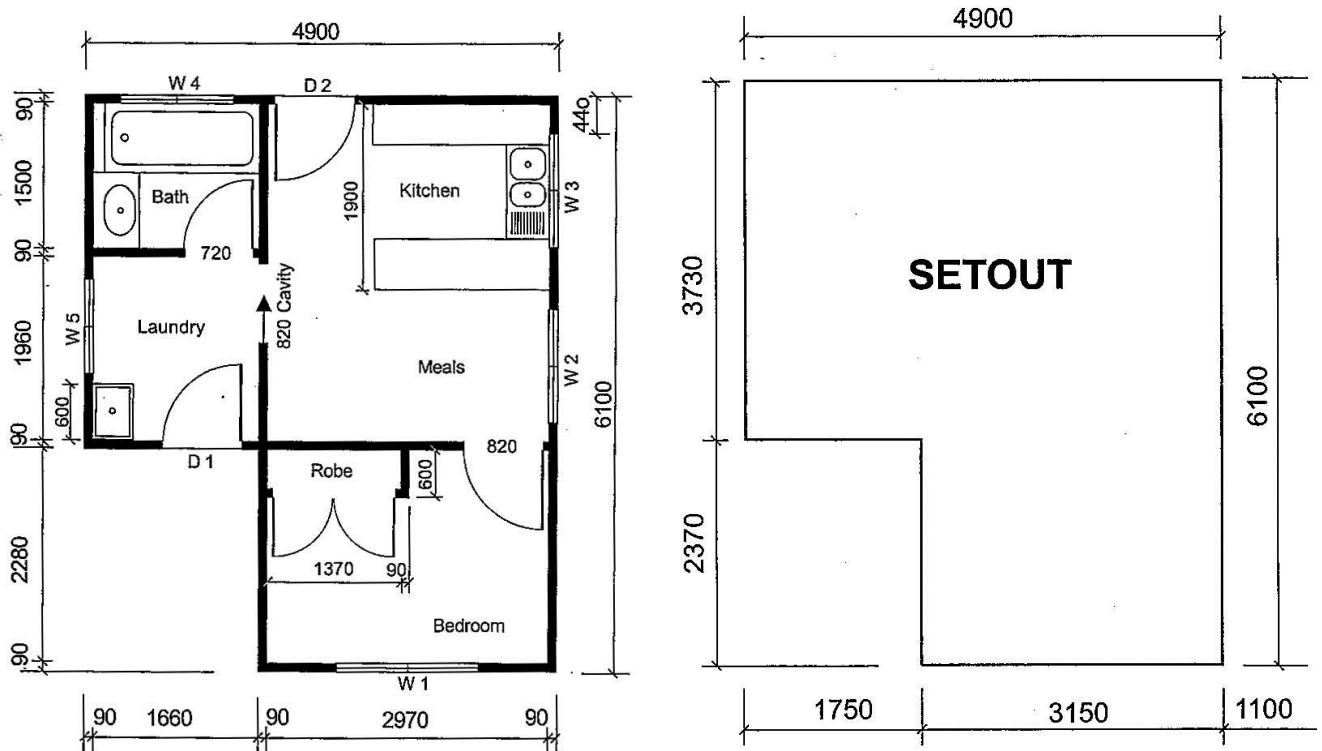

L shaped house plan and set out

Provide clearance between the work and profiles

The first trade to use the profiles will be the excavator, so a reasonable clearance between the work and the profile itself is needed, this will allow the machine to do its job without destroying a hurdle here or there. The best approach is to leave as much room as possible.

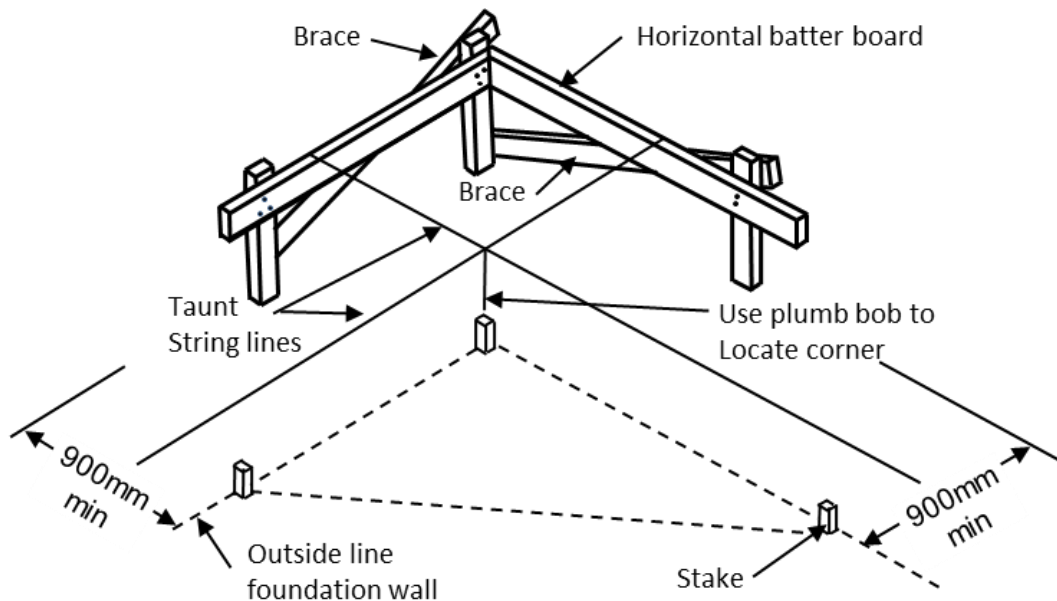

Provide clearance between work and profile

Student Learning Guide & Record

TASK	PAGE	NAME	DATE COMPLETED	INSTRUCTOR'S SIGNATURE
Assessment 1	17	Hurdles/Building profiles		
Assessment 2	18	Check an existing building for square		
Assessment 3	20	Research the steps required to set out a building		
Assessment 4	28	Identify tools and equipment required to set out a building		
Assessment 5	29	Write a procedural list on how you will set out a building		
Assessment 6	30	Investigate Australian standards		
Assessment 7	30	Reflection – Setting out a building		

OBSERVATION OF PERFORMANCE

VU20973 Basic setting out

Has the learner?:	Yes	No
Complied with OHS legislation, regulations, Codes of Practice applicable to workplace operations.	<input type="checkbox"/>	<input type="checkbox"/>
Complied with workplace/organisational policies and procedures.	<input type="checkbox"/>	<input type="checkbox"/>
Communicated and worked safely and effectively with others.	<input type="checkbox"/>	<input type="checkbox"/>
Selected and used materials, tools and equipment for setting out.	<input type="checkbox"/>	<input type="checkbox"/>
Completed set out for one rectangle and one L-shaped building according to a plan for a specific building.	<input type="checkbox"/>	<input type="checkbox"/>
Squared a corner of a building set out using the 3-4-5 triangle method.	<input type="checkbox"/>	<input type="checkbox"/>

Is the learner **C** competent or **N** not yet competent?

C

N

Outline further training if required here

Assessors comments

Assessor's name:

Signature: Date:

I acknowledge that I have been informed of the assessment decision and agree to the proposed training plan (if required).

Student's name:

Signature: Date: