

Emmo F6

Owner's Manual



GREEN YOUR LIFE

V 1.0, J. Lu, M. Wu

Table of Contents

MTO Label.....3

Specifications.....4

Charging Your E-bike5-6

Adjusting Brakes and Tire Air Pressure.....7

Side Stand and Foldable Pedals.....8

Ignition.....9

Left and Right Side of the Handlebar and Throttle.....10

Folding Your E-bike11

Greasing Bike Chain.....12

E-bike Registration.....13

Contact Us.....14

E-bike MTO Label

**THIS VEHICLE IS A POWER
ASSISTED BICYCLE AND
MEETS ALL THE
REQUIREMENTS UNDER
SECTION 2(1) OF THE
CANADA MOTOR VEHICLE
SAFETY REGULATIONS.**

**CE VÉHICULE EST UNE BICYCLETTE
ASSISTÉE ET RECONTRE LA NORME 2(1)
DU RÈGLEMENT SUR LA SÉCURITÉ
DES VÉHICULES AUTOMOBILES DU CANADA.**

WARNING!

Please make sure this MTO label is on your e-bike. If this label is not present, please ask your dealer to put one on. All electric bicycles are required to have this sticker on the bike for it to be a legal vehicle.

Specifications

Color:	Silver; Red; Green; Yellow
Special Feature:	Foldable Bike Style, Lithium Battery, 6 Speed, Lightweight, Aluminum Foldable Frame
Wheel Size:	20" x 1.95"
Net Weight:	25Kg
Maximum Speed:	30 km/h
Travel Range:	40-45 km*
Charging Time:	3 – 6 Hours
Climbing Angle:	15 Degrees
Load Capacity:	120kg
Motor:	Maximum 350W Brushless / 36V DC
Battery:	36V/10Ah Lithium Battery
Charger:	AC100-120V, Smart Charger (Battery maintained while charging)
Front Brake:	V Brake
Rear Brake:	V Brake
Lock System:	Key ignition lock, Battery lock
Meter & Indicator:	Battery Strength Indicator, Power Assist Level Indicator
Lighting System:	LED Headlight (White), Tail Light
Storage:	Front basket
Gears:	6 Speed

*Travel range is based on riding on level ground, no stops, no winds, warm temperatures for a 175lb rider with no extra cargo.

Charging the Bike

Charging the battery is done from the charger port located on the battery itself. The charger is separated into two different parts: A cable with one end that goes into a 110V power outlet, and the other end that goes into the charger box itself, the charger box with a cable that plugs into the bike.

1. Take the cable from the charger box and plug it into the charger port located on the battery itself.
2. Plug one end of the separate cable into the charger box.
3. Plug the other end of the cable into a power outlet.
4. Confirm that the charging indicators turn red.

Note: When the battery is fully charged, the charging indicator will turn green.

5. Unplug the charger from the power outlet.
6. Unplug the charger from the battery.

Note: The charger light must be red when both plugs are plugged in. It will always turn red first if the bike has been used. It will turn green after it is fully charged.

WARNING!

Charge the bike for no more than 8 hours (lithium ion batteries).

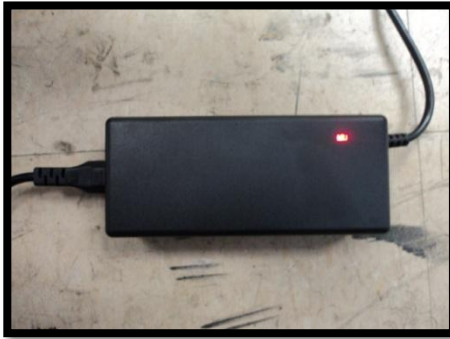

WARNING!

***CHARGING THE E-BIKE SHOULD TAKE A MAXIMUM OF 6 HOURS.**

***DO NOT CHARGE THE E-BIKE FOR MORE THAN 8 HOURS. OVERCHARGING WILL OVERHEAT THE BATTERY, CAUSING DAMAGE TO THE BATTERY.**

***DURING LONG PERIODS OF INACTIVITY, MAKE SURE THAT THERE IS MORE THAN 25% POWER IN THE BATTERY, THEN REMOVE THE BATTERY FROM THE BIKE.**

(THE BATTERY LIFE CAN BE CHECKED ON THE INDICATOR LOCATED AT THE LEFT SIDE OF THE HANDLEBAR.)

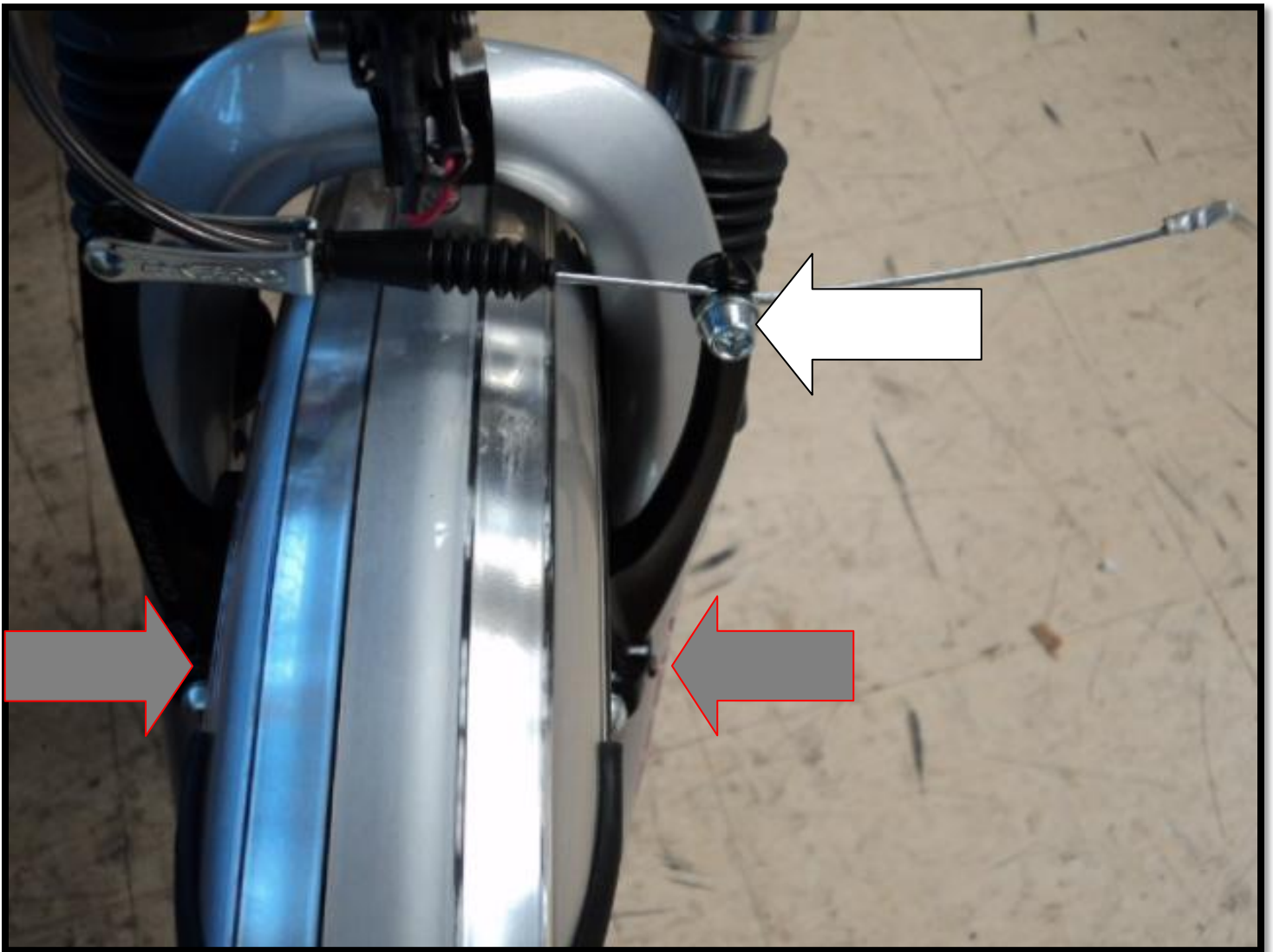

Adjusting Brakes (Front and Back)

Loosen the screw identified on the picture above (**white arrow**) and pull the wire to the right in order to tighten the brakes. Pull the wire to the left to loosen the brakes. Tighten the screw after finishing the adjustments.

The brake pads can also be adjusted. Turning the screw, identified with **gray arrows** on the picture, clockwise will cause the screw to move inwards, making the pads move outwards. Similarly, turning the screw counter clockwise will cause the screw to move outwards, making the pads move inwards.

Note: Both pads function together; adjusting only one brake pad may not have any impact on braking system. Be sure to adjust both brake pads when working with this adjustment.

Tire Pressure

The recommended air pressure for the tires is 50 psi. Check the tire pressure once a month.



Side Stand

The side stand is similar to other bicycles – flick it downwards such that it sticks out, as shown in the picture, then lean it to the left.

Foldable Bike Pedals

To fold the bike pedals, push the pedal inwards and lift up.

WARNING!

The law requires all e-bikes to have pedals installed. If the pedals are off, these vehicles will be considered a motorcycle, which do not follow the same regulations as e-bikes.



Key Positions in Ignition

1. This is the 'on' position. This position is reached when the key is turned to the right, from the off position. The bike will turn on, and all functions on the handlebars will work.
2. This is the 'off' position. The key simply rests in the bike, and the bike is not turned on.
3. This is the battery unlock position. This position is reached by pushing the key in, then turning to the left (from the off position). When the ignition is in this position, the battery lock is disengaged and the battery can be removed from the bike.

WARNING!

Do not turn on the bike without sitting on it first, otherwise you will risk touching the throttle by accident and having it run off by itself.

Gear Control

Pushing the upper button lowers the gear (i.e. From 5 → 4). Pushing the lower button ('+') raises the gear (ie. From 5 → 6).

Front Brake

Pulling this lever will activate the front brake.

Throttle

Turning the throttle towards the rider causes the back wheel to accelerate.

Throttle Control

This button controls the throttle. When this button is pushed out, pulling the throttle will not cause anything to happen. When the button is pushed in, the throttle works as normal.

Bell

Pulling and releasing the black stopper will sound the bell.

Back Brake

Pulling this lever will activate the back brake.

Headlight

This button turns on the light above the front wheel.

Battery Indicator

These lights indicate the remaining battery level. (Low → High)

Motor Assistance

These buttons adjust the level of motor assistance provided to the bike. ('+' increases the level of motor assistance, '-' decreases the level of motor assistance.) This can be adjusted to 4 different settings: Off, Low, Medium, High.

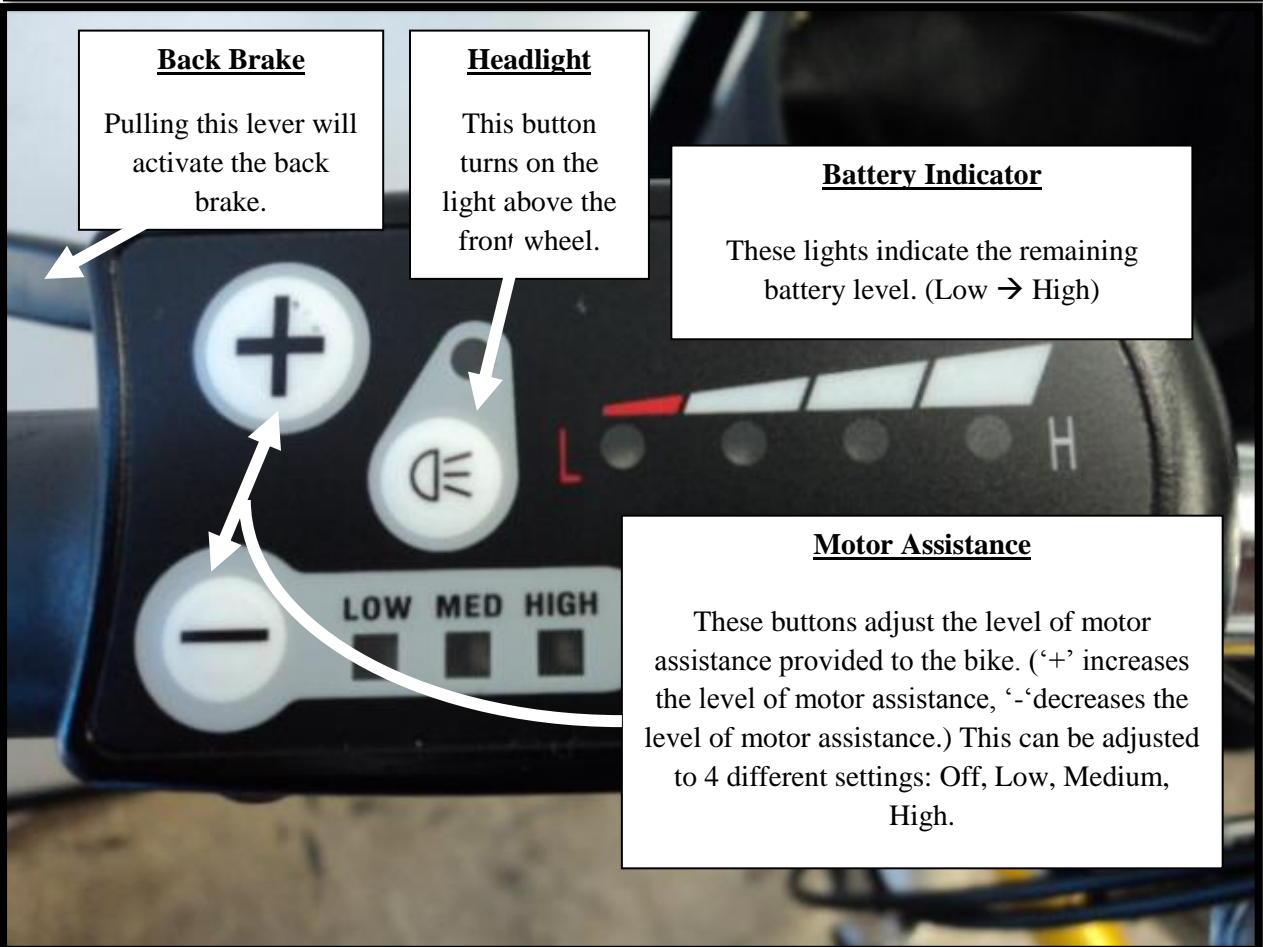
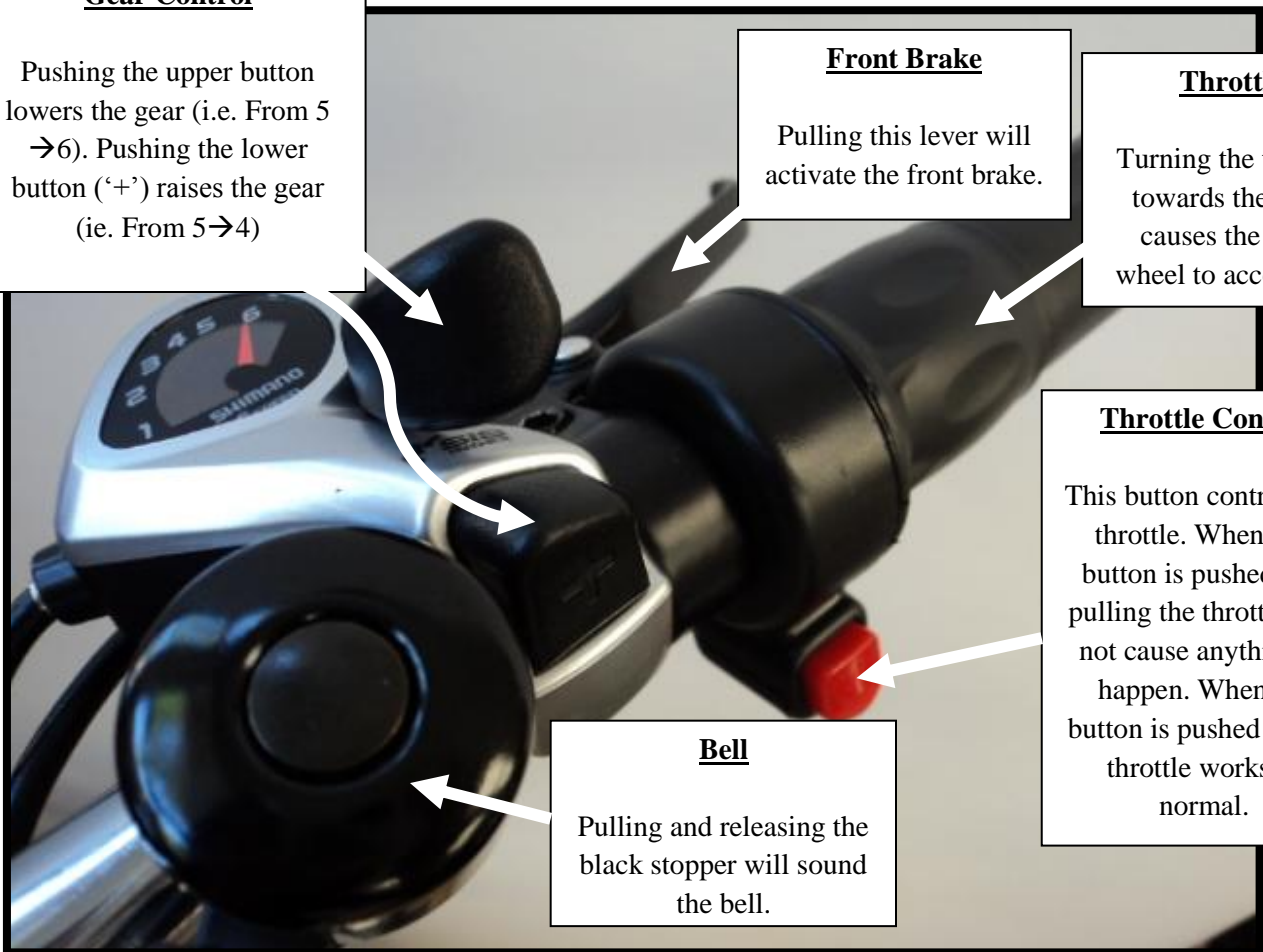

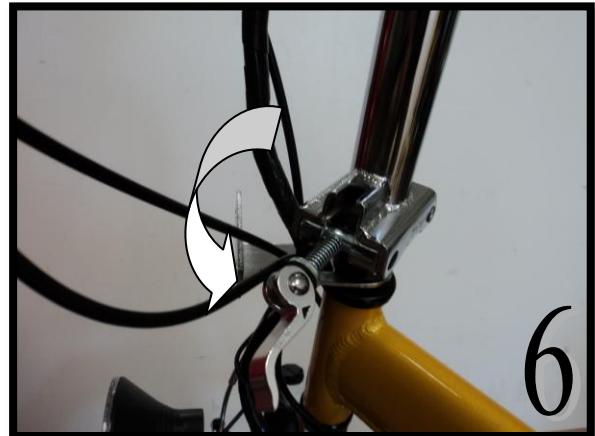
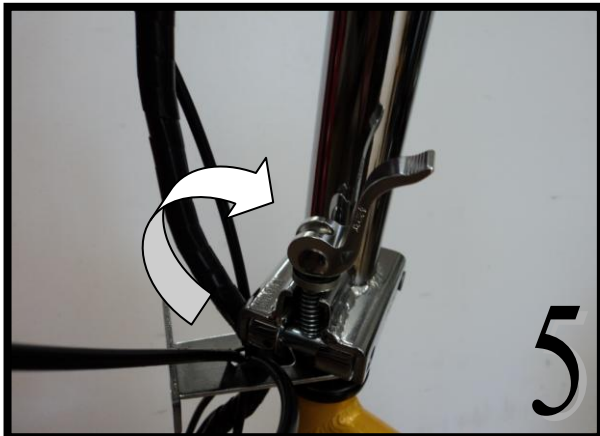
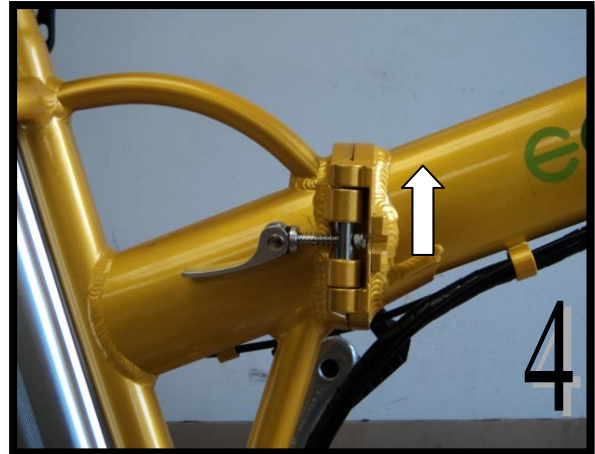
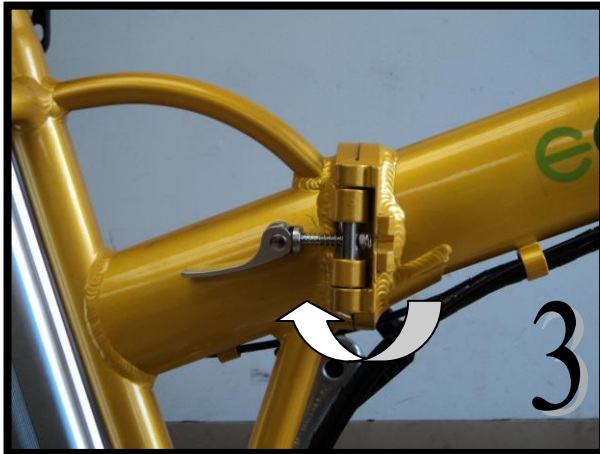

Steps 1-7 listed above are visual representations of how to fold the Emmo F6.



Note: Grease the bike chain once a month for maximum efficiency.

E-Bike Registration

Once you have purchased an Emmo E-bike, please register your vehicle with us to validate your warranty.

In order to register your e-bikes, please follow the steps listed below:

1. Fill out the following form:

Invoice Number:

Store Location:

Customer Name:

Address:

Phone Number:

E-mail:

Survey:

How did you find out about Emmo Inc.? (Please select the options that apply)

☐ Returning Customer ☐ Family/Friend ☐ Passing by Store ☐ Kijiji
☐ TERA ☐ Google ☐ Yelp ☐ Other _____

2. Send the information listed above to our e-mail: info@emmo.ca

3. Wait for a confirmation e-mail from Emmo Inc.

Thank you for Choosing



GREEN YOUR LIFE

Connect With Us!

Stay tuned for updates regarding new e-bike models, special deals and more!

Official Website: www.emmo.ca



www.facebook.com/EmmoCanada



info@emmo.ca

Any laws/regulations regarding "E-bikes" can be found on the Ministry of Transportation website:

www.mto.gov.on.ca

If you have further questions, please contact us at:

438 Spadina Avenue, Toronto ON

Toll Free: 1 888 510 3666 Tel: (416) 792-3227 Fax: (416) 792-6736