

ATTACHING RAMPS

Situations change and often ramps are used on multiple vehicles or in different situations. Traditionally ramps can only be secured using a pin, Digga Ezi Loada ramps give you 3 methods.

1. PIN METHOD

The ramp is lined up with the holes that are on the edge of the tray. Once aligned, a pin is inserted through ramp and tray to lock it in to place. The ramp is then secured by inserting an R Clip through the pin.

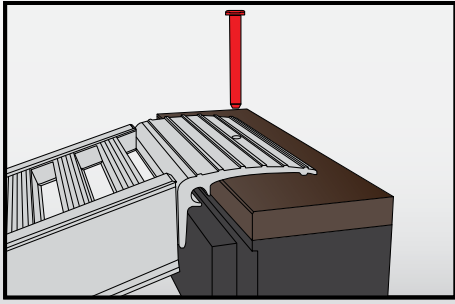

2. TONGUE METHOD

The tongue is placed between the truck bed and the tail gate. The shape of it will not allow the ramps to "pop" out of the gap while the machine is on the ramp.

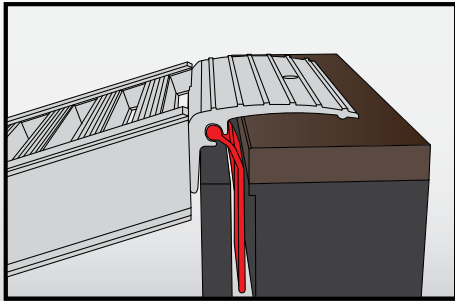

3. CHAIN METHOD

A chain and shackle can be fitted to the weldment underneath the ramp then connected to the tail gate bar underneath the truck-chain not supplied (Note, this is a secondary attachment method and should not be used without a pin or tongue)

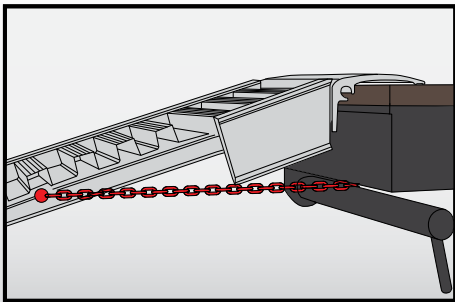

DIGGA

DIGGA AUSTRALIA

4 OCTAL STREET
YATALA QLD 4207
AUSTRALIA

PH: (07) 3807 3330
EMAIL: INFO@DIGGA.COM

WWW.DIGGA.COM

PH: 1300 2 DIGGA

FOR FURTHER INFORMATION PLEASE CONTACT YOUR LOCAL AUTHORISED DIGGA DEALER

QLD / NT

Email: info@digga.com

NSW / ACT

Email: nsw@digga.com

VIC / SA / TAS

Email: vic@digga.com

WA

Email: diggawest@bigpond.com

Digga NZ Pty Ltd

Ph: +64 9262 3500

Email: sales@digga.co.nz



IMPORTANT: The attachments shown in this brochure are for illustrative purposes only and may include some non-standard optional extras. All specifications should be regarded as approximate only. For full details contact your Digga Dealer. In the interest of product improvement, Digga reserves the right to change these specifications without prior notice.

THE RAMP REVOLUTION IS HERE



EZI-LOADA



DIGGA RAMPS IT UP

A light weight ramp, with enhanced safety, that delivers on quality, performance and is cost effective.

European designed and engineered, the new Digga Ezi Loada ramps are the most advanced design on the Australian market today.

NEW FEATURES

- 3 different connection options
- Enhanced rail strength
- Patented, extruded, double T rail with interlocking rung design
- Superior strength & durability

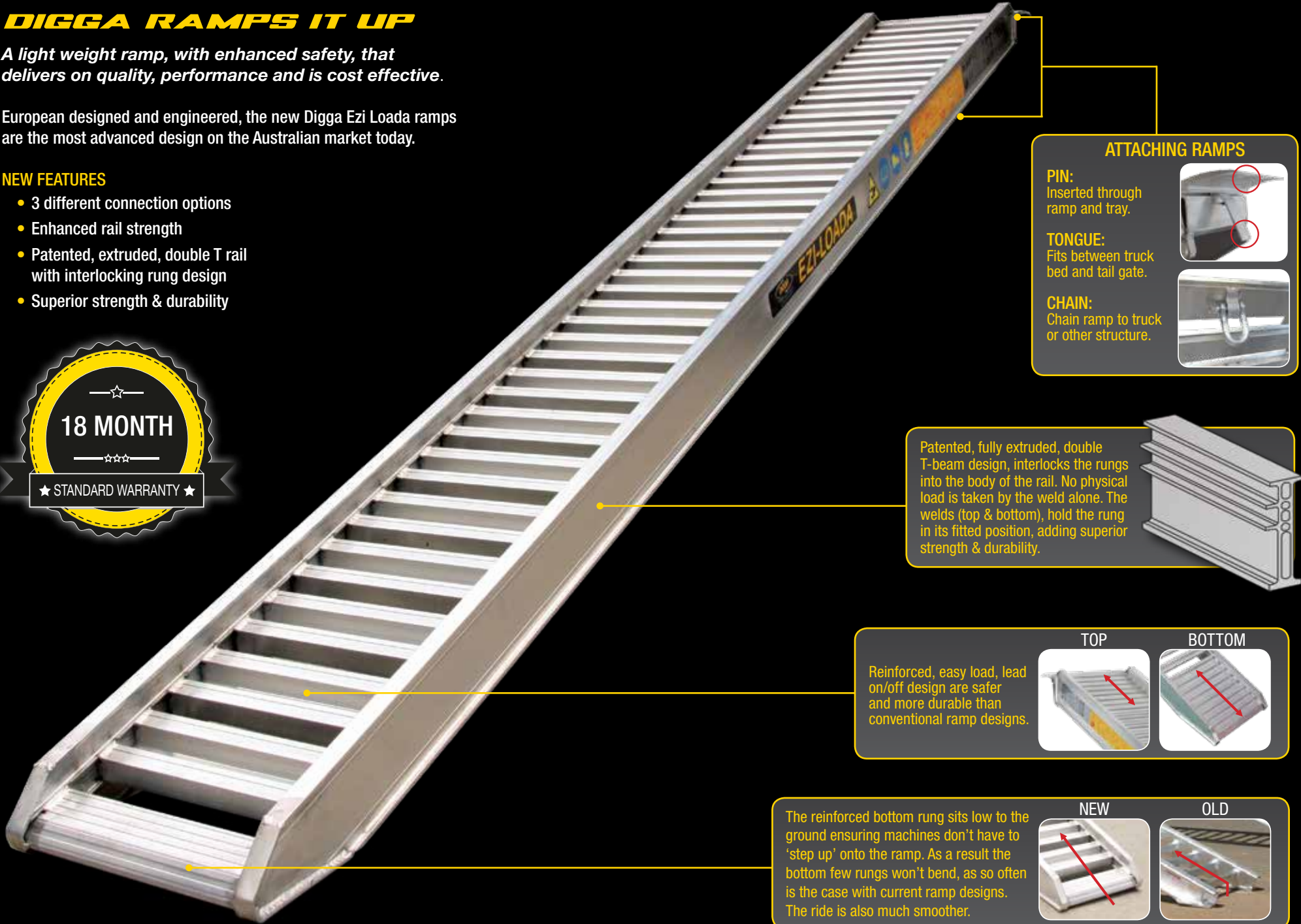

ATTACHING RAMPS

PIN:
Inserted through ramp and tray.



TONGUE:
Fits between truck bed and tail gate.



CHAIN:
Chain ramp to truck or other structure.

Patented, fully extruded, double T-beam design, interlocks the rungs into the body of the rail. No physical load is taken by the weld alone. The welds (top & bottom), hold the rung in its fitted position, adding superior strength & durability.

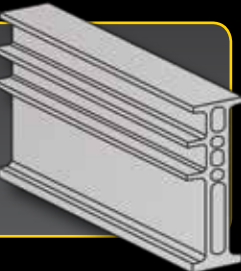

Reinforced, easy load, lead on/off design are safer and more durable than conventional ramp designs.

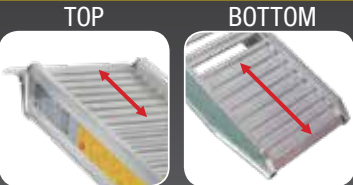

The reinforced bottom rung sits low to the ground ensuring machines don't have to 'step up' onto the ramp. As a result the bottom few rungs won't bend, as so often is the case with current ramp designs. The ride is also much smoother.



STANDARD RANGE

RUBBER WHEELS & RUBBER TRACKS - 2T TO 6.2T

- Rung design prevents clogging up with mud, stones & other debris reducing risk of tyre/track slippage.
- New rung design cleans the wheels/tracks as the machine climbs the ramp, minimizing debris taken onto the truck bed.
- Rung Design allows the operator to safely walk up the ramp.
- Smoothest ride of any ramp on the market.



UNIVERSAL RANGE

ALL MACHINES WHEELED, STEEL & RUBBER TRACKS - 5.2T TO 9T

The first dual purpose ramp available for rubber/steel tracked machines as well as wheeled machines.

- Patented, studded rungs minimise slip or loss of grip during the loading/unloading activity.
- Rungs are level with the top of the main supporting rail minimising wear & providing greater durability.
- Superior strength, versatility and safety.

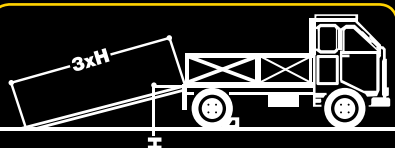

IT IS RECOMMENDED THAT THE MAX LOADING HEIGHT BE NO GREATER THAN 1/3 THE LENGTH OF THE RAMP

CERTIFIED TO THE HIGHEST INTERNATIONAL STANDARDS
GUARANTEEING THE QUALITY AND SAFETY OF THE RAMPS



SPECIFICATIONS

Code	Description	Beam	Int Width	Ext Width	Weight Per Ramp
LR152530	Standard	64mm	255mm	300mm	14kg
LR233030	Standard	100mm	300mm	360mm	23kg
LR303030	Standard	115mm	300mm	360mm	26kg
LR303535	Standard	120mm	300mm	360mm	36kg
LR353535	Standard	125mm	350mm	410mm	37kg
LR403545	Standard	140mm	450mm	510mm	46kg
LR473545	Standard	155mm	450mm	510mm	46kg
LR473550	Standard	165mm	500mm	560mm	51kg
LR593545	Standard	150mm	450mm	510mm	53kg
LRU593550	Universal	150mm	500mm	560mm	60kg
LRU663550	Universal	170mm	500mm	560mm	61kg
LRU823550	Universal	180mm	500mm	560mm	77kg

CHOOSING YOUR RAMP

A MACHINES WHEELBASE LENGTH IS IMPORTANT WHEN CHOOSING RAMPS. A LONGER WHEELBASE WILL DISTRIBUTE THE WEIGHT OF THE MACHINE OVER A WIDER AREA OF THE RAMP INCREASING ITS ABILITY TO HANDLE MORE LOAD. NARROW WHEELBASES PUT MORE WEIGHT ON A SMALLER AREA OF THE RAMP LOWERING ITS CAPACITY.

1. CHECK THE MACHINES WHEELBASE

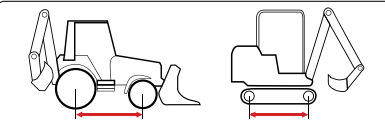

2. ONCE YOU KNOW THE WHEELBASE LENGTH USE THE TABLE BELOW TO WORK OUT WHICH RAMP IS BEST SUITED FOR YOUR MACHINE



RAMP CAPACITY Vs WHEELBASE LENGTH

Code	Capacity @ Wheelbase	Length
LR152530	1.5 tonne @ 1 m	2480mm
LR233030	2.0 tonne @ 1 m	3000mm
LR303030	3.0 tonne @ 1.2 m	3000mm
LR303535	3.0 tonne @ 1.2 m	3500mm
LR353535	3.5 tonne @ 1.5 m	3500mm
LR403545	4.0 tonne @ 1.5 m	3500mm
LR473545	4.7 tonne @ 1.5 m	3500mm
LR473550	4.7 tonne @ 1.5 m	3500mm
LR593545	5.9 tonne @ 1.5 m	3500mm
LRU593550	6.2 tonne @ 2.0 m	3500mm
LRU663550	7.0 tonne @ 2.0 m	3500mm
LRU823550	9.0 tonne @ 2.0 m	3500mm