

# DSA

*Door technical details*

## "DSA" DOOR SET

- 1 Frame
- 2 Door leaf
- 3 Hinges
- 4 Threshold (or no threshold)
- 5 Mortise lock (according to specifications)
- 6 Insulation seal
- 7 Hinge protective bolts (for fire and/or burglary-resistant doors)
- 8 Fire expanding gasket (for fire-resistant doors)
- 9 Product identification label



*Multi-purpose,  
certified steel door.*

## MAIN PROPERTIES



**EI<sub>2</sub>30 / EI<sub>2</sub>60**  
FIRE RESISTANCE



**S<sub>a</sub>, S<sub>200</sub>**  
SMOKE RESISTANCE



**RC 3**  
BURGLARY  
RESISTANCE



**1.5 W/(m<sup>2</sup>·K)**  
THERMAL  
CONDUCTIVITY

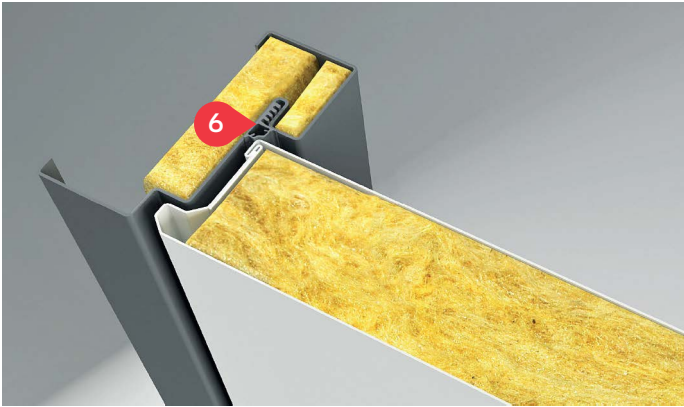

**41 dB**  
SOUND INSULATION

**"DSA" DOOR SET****DSA DOOR CROSS SECTION**

The door is made of galvanised steel, primed and powder-coated. The door is filled with high density mineral wool.

**LOCK**

We use various Scandinavian and European fire-resistant, protective locks, including multipoint locks, to meet all of our customer needs.

**INSULATION SEAL**

The door frame features an inserted door insulation seal (6) and the door leaf – a glued fire expanding gasket (8).

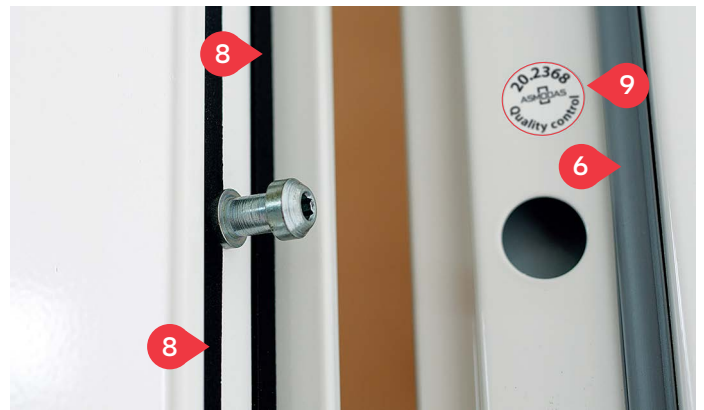
**SECURITY HINGE BOLTS**

Special bolts, protecting the doors from hinges dismantling, and the leaf – from deformation, caused by high temperature (in case of fire).

**HINGES**

Galvanised, adjustable hinges. May be painted (on the customers request).

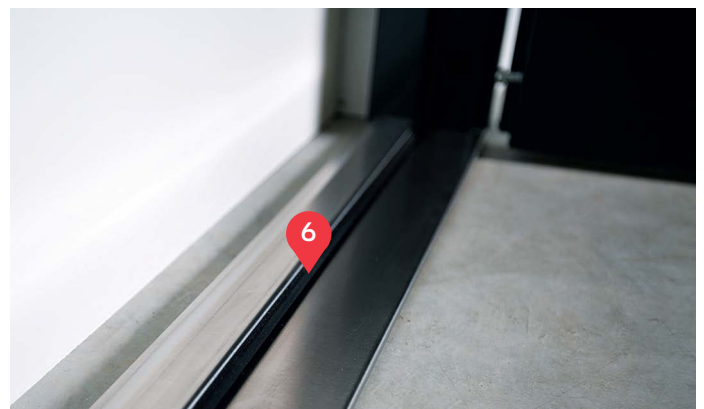
**THRESHOLD**

May be galvanised, painted, made of stainless steel or oak. The door leaf can also be equipped with a drop-down seal.



### "DSA" DOOR ACCESSORIES



#### MECHANICAL DOORBELL

In case of a need, door bell can be mounted in a factory. Fire doors are tested with mechanical bell (EI<sub>2</sub>30 / EI<sub>2</sub>60).



#### DOOR FRAME ADJUSTMENT BOLTS

For adjusting the frame while installing the door. They also serve to protect the installation bolts from cutting.



#### STRIKE PLATE

For smooth closing of the door and lock adjustment.



#### SUB-FRAME

For covering the wall opening. Manufactured according to the wall parameters.



#### DOOR CLOSER

Recommended for all fire safety doors.

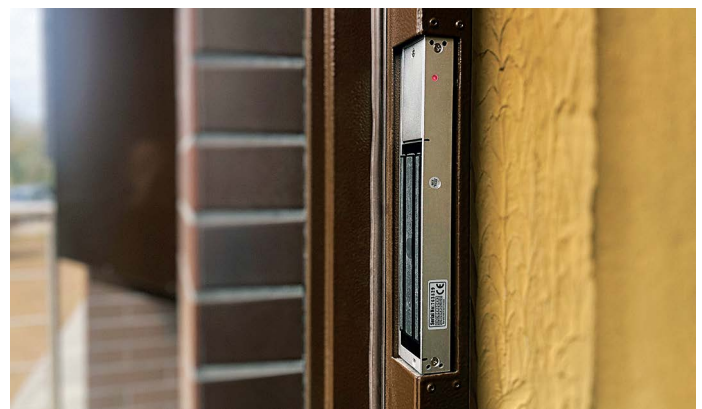

#### ELECTRIC STRIKE

Used for access control.

“DSA” DOOR FRAME TYPES

DOOR FRAME – C

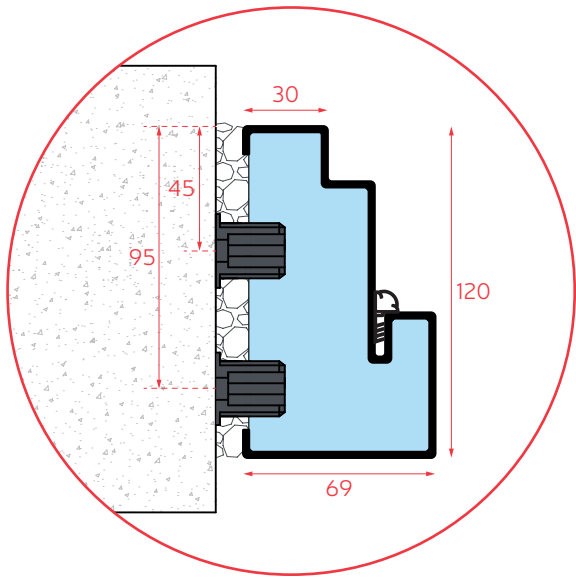

DOOR FRAME – C50

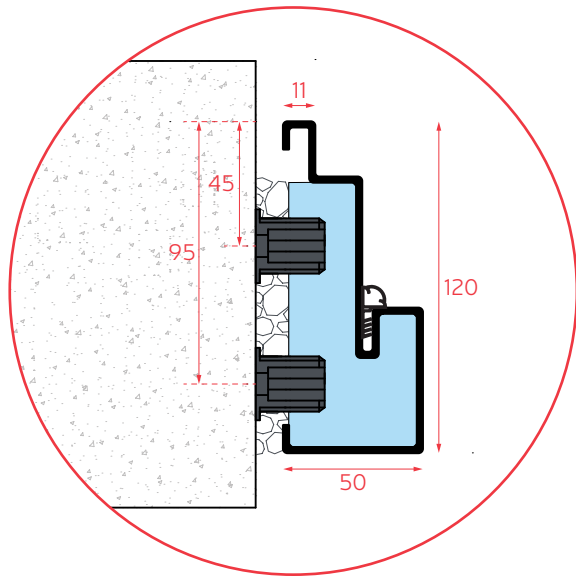

DOOR FRAME - B

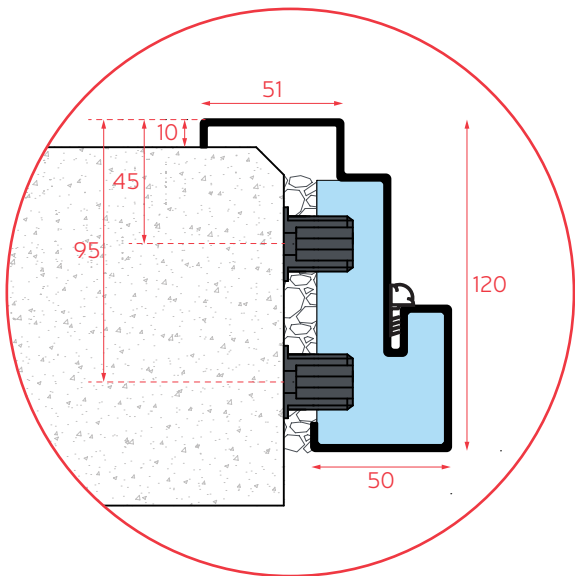

DOOR FRAME B WITH SUB-FRAME

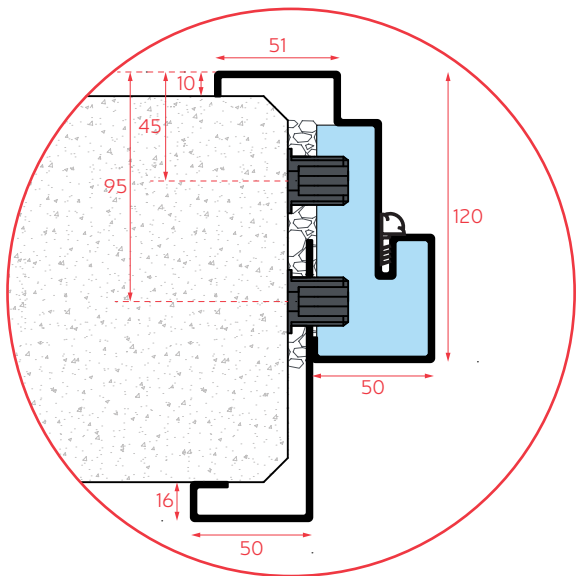

DOOR OPTIONS

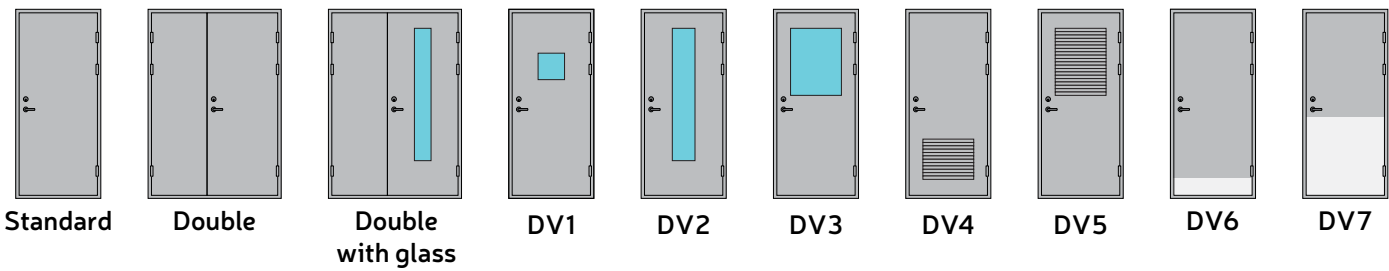

## "DSA" THRESHOLDS

**LN 8/20**

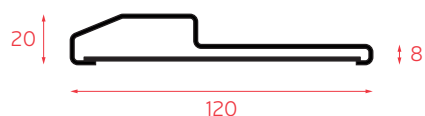

**LN 12/25 \***

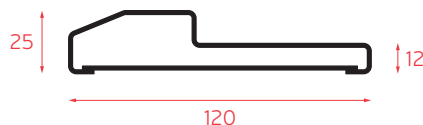

**L12/25 \***

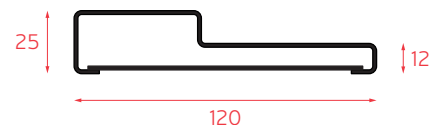

**L20/35 \***

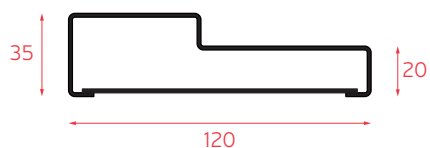

**L30/45 \***

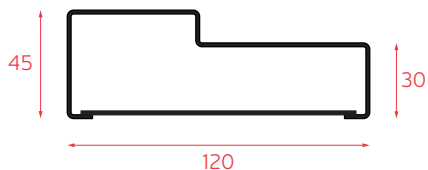

**L40/55 \***

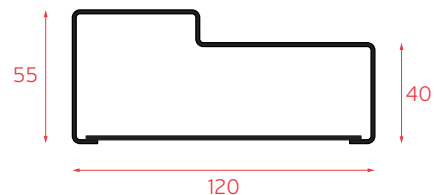

**L20/5**

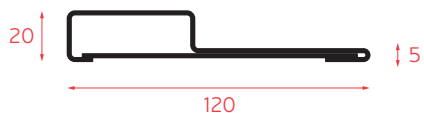

**Drop-down seal**

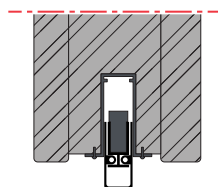

**Slaplist**

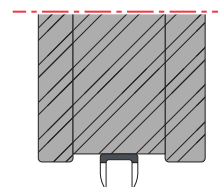

**I4**



\*This type of thresholds may be manufactured of solid oak.

## OPENING DIRECTIONS

### SINGLE LEAF DOOR

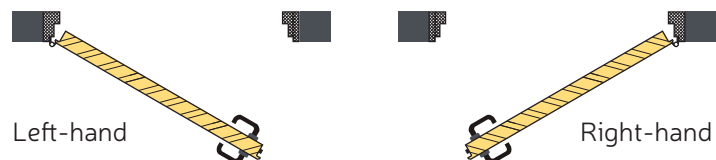

### DOUBLE LEAF DOOR



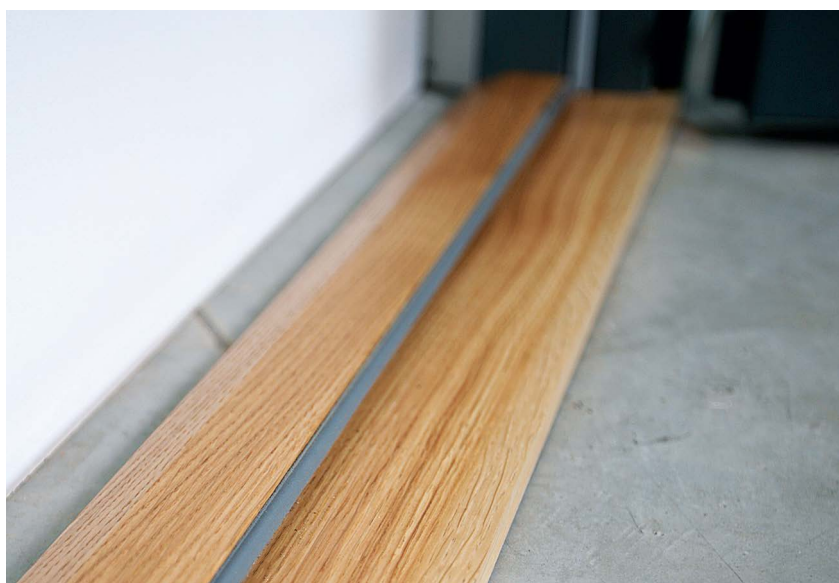
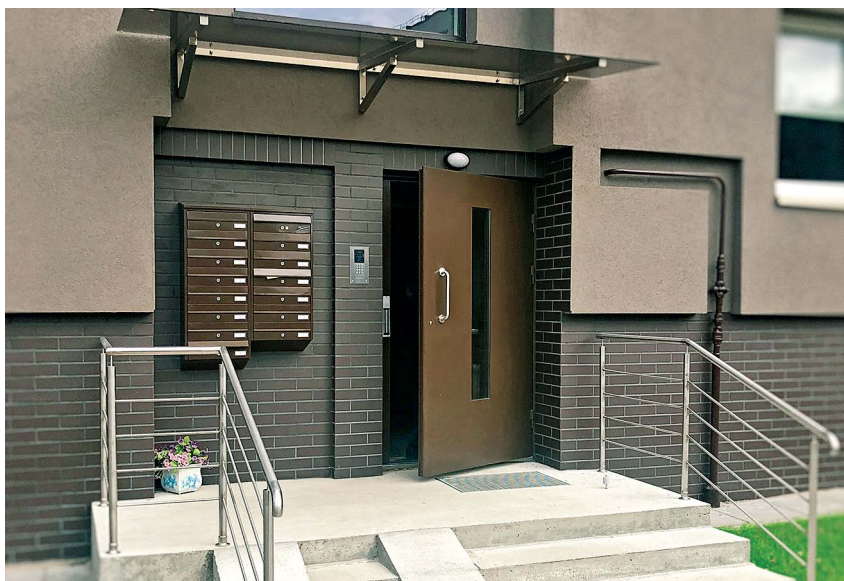



**JSC ASMODAS**  
**Skaidrioji str. 22-1**  
**Lithuania, LT 96155 Gargzdai**

**[www.asmodas.eu](http://www.asmodas.eu)**  
**[info@asmodas.lt](mailto:info@asmodas.lt)**  
**+370 463 427 27**



SCIENCE • ECONOMY • COHESION



EUROPEAN UNION

*Creating the Future of Lithuania*

European Regional Development Fund