

---

**SUITE  
305**

2,747 SF

---

**JOE STEVENS**

+ 312.881.7095

[joe.stevens@transwestern.com](mailto:joe.stevens@transwestern.com)

**JOHN NELSON**

+ 312.257.2892

[john.nelson@transwestern.com](mailto:john.nelson@transwestern.com)

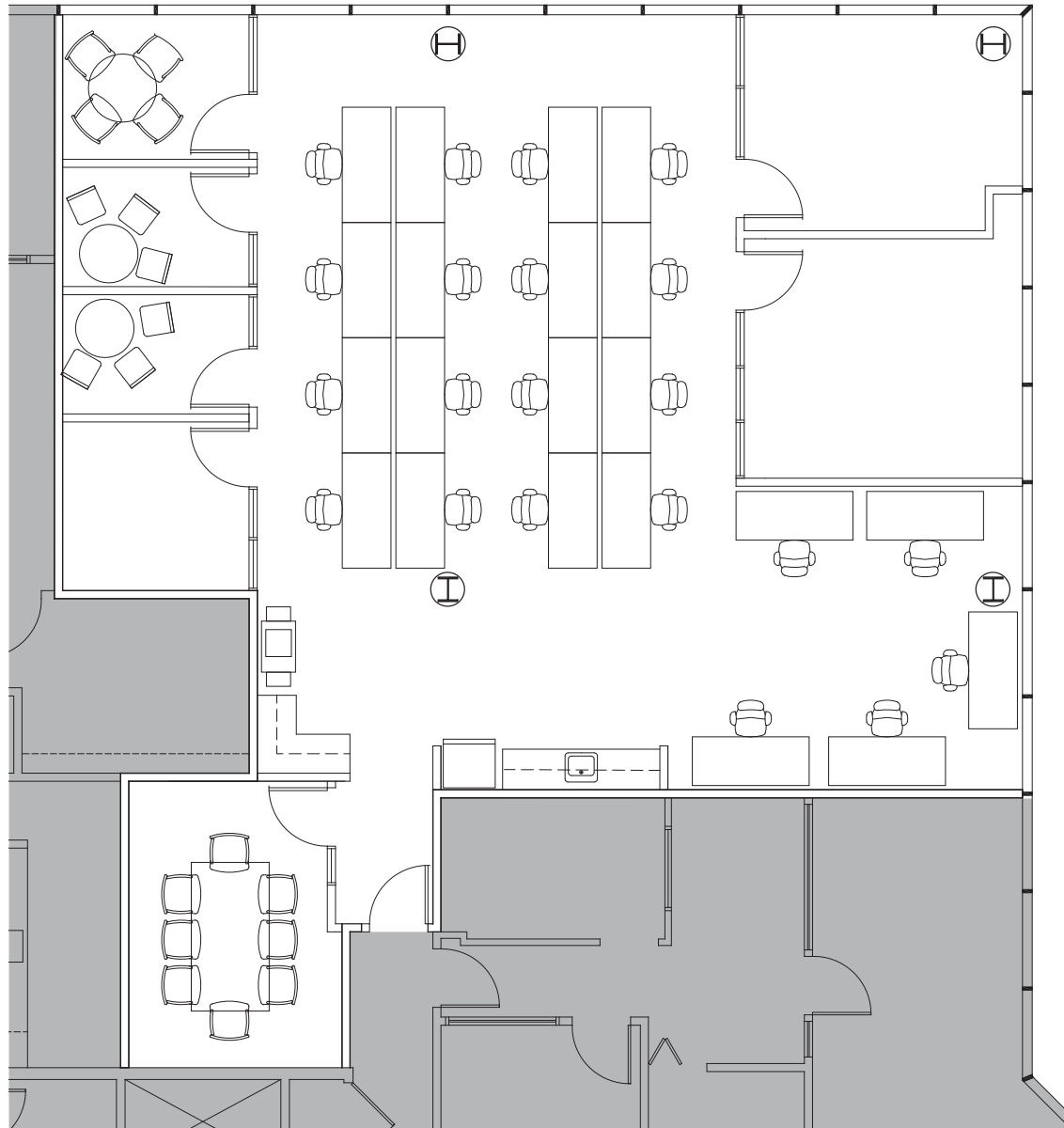

21 work stations | 3 offices | 1 huddle room | 2 breakrooms | 1 conference | 1 coffee bar