

SOUND INSULATION MATERIALS

VETUS sound insulation, discover peace and quiet!

VETUS sound insulation is a versatile range of materials especially developed for marine applications. These products are liquid tight, fire resistant and consist of the highest quality insulation foams. VETUS' product lines are based on 2 insulation foams, Sonitech and Promotech, and are available in various sheet thicknesses. The sound absorption coefficients of these base foam materials are tested according to ISO 10534.

Base materials

The range is built around a number of base materials. Various compositions of these base materials form the four main product lines, which are available in various sheet thicknesses. In the selection table below the possible combinations are presented, to help you select the correct product for your application.

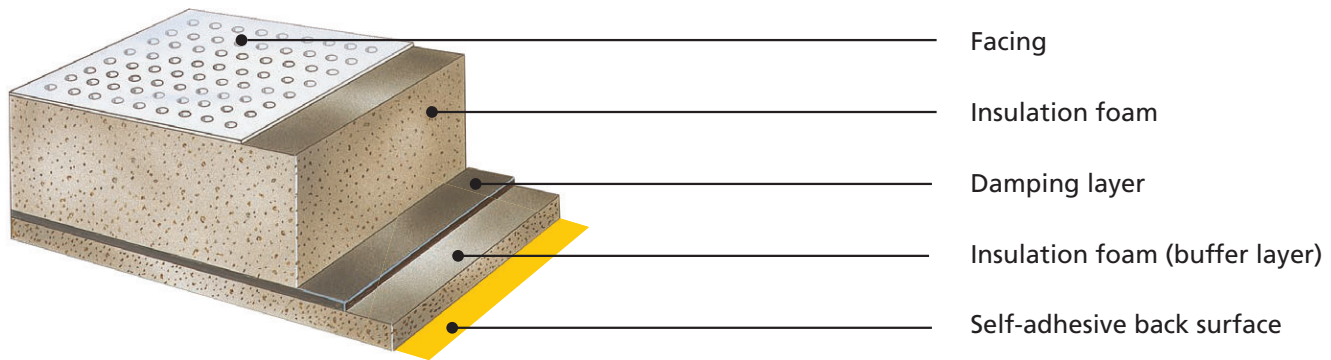

Sound insulation

The sound absorption coefficients of both base foam materials are tested according to ISO 10534.

Guaranteed fire resistance; Class 0

The 'BS476 Class 0' fire resistance rating is the most demanding rating on the market today. To achieve class 0 the product must achieve:

- BS476 part 7, Surface spread of flame, Class 1
- BS476 part 6, Fire propagation, Index I <12 and i1 < 6

This means that the material does not spread flames and limits the amount of heat released from the surface during a fire.

| Range | | Sonitech light | | | | Sonitech single | | | | Promotech single | | | | | Promotech double | | | | | | |
|--|--------------------------|----------------|--------|--------|--------|-----------------|--------|--------|--------|------------------|--------|--------|--------|--------|------------------|--------|--------|--------|--------|--------|--------|
| Product code (All sheets are 600 x 1000 mm) | | ST020A | ST040A | ST020W | ST040W | ST135A | ST145A | ST135W | ST145W | PT112A | PT135A | PT145A | PT112W | PT135W | PT145W | PT225S | PT245S | PT260S | PT225W | PT245W | PT260W |
| Material | Sonitech | • | • | • | • | • | • | • | • | | | | | | | | | | | | |
| | Promotech | | | | | | | | | • | • | • | • | • | • | • | • | • | • | • | • |
| | Number of damping layers | 0 | 0 | 0 | 0 | 1 | 1 | 1 | 1 | 1 | 1 | 1 | 1 | 1 | 1 | 2 | 2 | 2 | 2 | 2 | 2 |
| | Total thickness | 20 | 40 | 20 | 40 | 35 | 45 | 35 | 45 | 12 | 35 | 45 | 12 | 35 | 45 | 25 | 45 | 60 | 25 | 45 | 60 |
| Facing | Aluminium | • | • | | | • | • | | | • | • | • | | | | | | | | | |
| | White foil | | | • | • | | | | | | | | | | | | | | | | |
| | Glass cloth Silver | | | | | | | | | | | | | | • | • | • | | | | |
| | Glass cloth White | | | | | | | • | • | | | | • | • | • | | | | • | • | • |
| Back | Self-adhesive | • | • | • | • | • | • | • | • | • | • | • | • | • | • | • | • | • | • | • | • |
| Weight | (kg) | 0,4 | 0,7 | 0,4 | 0,7 | 3,6 | 3,8 | 3,6 | 3,8 | 3,6 | 4,9 | 5,4 | 3,6 | 4,9 | 5,4 | 7,2 | 7,8 | 9,2 | 7,2 | 7,8 | 9,2 |
| Class 0 | Fire resistant | | | | | | | | | • | • | • | • | • | • | • | • | • | • | • | • |

SOUND INSULATION MATERIALS

VETUS offers four product lines, based on two insulation foams; Sonitech and Prometech. Both foams have excellent sound reducing capabilities and are fire resistant. Prometech is rated to BS476 Class 0 fire resistance.

All sheets measure 100 x 60 cm and are supplied with a self-adhesive backing for quick and easy installation. The modified acrylic adhesive has high initial tack and adhesion of 1000 N/m to steel (ATM.1-PSTC.1).



Prometech double

Ultimate sound insulation and safety

This line is designed to absorb as much sound as possible. It is the top of the range product line with double damping layers.



Prometech single

Excellent sound insulation, highest safety level

This product has good sound reducing capabilities and the highest level of safety. Ideal for applications where space is limited.



Sonitech single

Good sound insulation capabilities

These sheets have a single damping layer resulting in good sound insulation. It gives excellent results at reasonable prices.

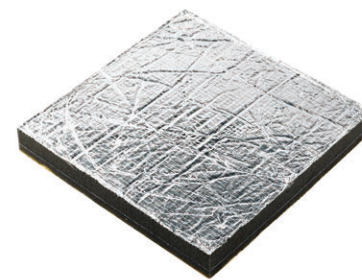

Sonitech light

Flexible and light-weight sheet

This product has efficient sound insulation and is ideal for use when cost or space is the prime concern.

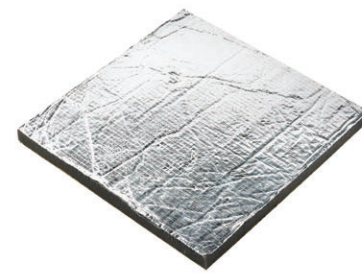

SOUND INSULATION MATERIALS

Installation guidelines

Preparing the engine room

Sound is like water and until the last gap is closed, it will find a way out of the engine room. Therefore it is important to cover as much of the surface in the engine room as possible and to close all possible leaks. Any small gaps or holes in, between or under the bulkheads should be filled with flexible sealant, foam or other material. When the 'engine room' is in direct contact with the bilge or other spaces that run through the boat, it is recommended to build bulkheads or a box around the engine.

Fitting the sheets

While fitting the sheets, work around obstacles by cutting the sheet into the right shape and try to fit the puzzle as neatly as possible before actually sticking the sheets in place. Note that tanks tend to amplify noise. When a tank is in the same space as the engine, cover the tank in insulation sheets or build a bulkhead between them.

Hatches and air intakes

Hatches and air intakes may leak noise. Hatches can be sound proofed by using an insulation tape between the touching surfaces. Air intakes however are more difficult to insulate, as the engine needs air for combustion and cooling. Creating a labyrinth or installing a special damper will generally solve the noise leak without choking the engine.

Sound deadening sheet type GF140S

Absorbing both high and low frequency noise and vibration

These modern light-weight sound deadening sheets are self-adhesive and have an aluminium face layer.

Specifications

- Dimensions 120 cm x 80 cm x 40 mm
- Weight per plate 5,6 kg
- Temperature resistance up to 140°C

| Type | Description |
|--------|----------------------------------|
| GF140S | Sound-deadening glass wool sheet |



GF140S

Sound deadening sheet type PU130S

Ideal for smaller engine installations

These sound deadening sheets have excellent noise and vibration reducing qualities and come in packs of 4 sheets.

Specifications

- Dimensions 100 cm x 50 cm x 30 mm
- Weight per plate 1,5 kg
- Temperature resistance -30°C to +90°C

| Type | Description |
|--------|---|
| PU130S | Sound-deadening sheets (pack of 4 sheets) |

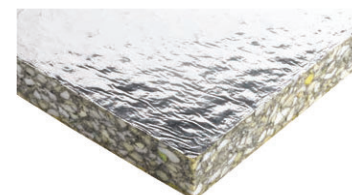

PU130S

SOUND INSULATION MATERIALS

Anti-reverberation material type ARM

Reduces structure borne sounds

Type ARM specifically reduces structure-borne sounds caused by, for example, the ship's propeller. These plates are suitable for steel and aluminium structures.

Specifications

- Plate dimensions 100 cm x 120 cm x 4 mm
- Weight per plate 8 kg
- Temperature resistance -10° C to +90°C



ARM10X12



Self-adhesive tape

Providing a neat and professional finish

When installing any VETUS sound insulation sheet, we recommend using these self-adhesive tapes to cover the joints.

Specifications

- Come in rolls of 30 m long and 50 mm wide
- Available in the colours grey (TAPEG30), white (TAPEW30) and aluminium (TAPEA30)



TAPE

| Type | Description |
|---------|-------------------------------|
| TAPEG30 | Self-adhesive tape, grey |
| TAPEW30 | Self-adhesive tape, white |
| TAPEA30 | Self-adhesive tape, aluminium |

Glass cloth tape

For use with glass cloth faced insulation sheets

This tape is perfect for sound insulation applications, requiring strength, flexibility and resistance to heat.

Especially suitable for use with the VETUS glass fibre faced sound isolation sheets.

Available in rolls of 50 m x 50 mm wide.



TAPEGF50

| Type | Description |
|----------|---------------------------------|
| TAPEGF50 | Self-adhesive tape, glass fibre |

SOUND INSULATION MATERIALS

Rosettes

For easy installation of heavy sheets

These fixing rosettes made of Polypropylene are ideal for easy installing of heavy sheets. They come in packs of 15 pieces (screw not supplied).

| Type | Description |
|------|---|
| FIXP | Ceiling rosette for fastening sound insulation sheets |

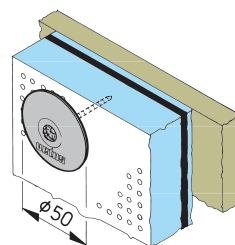

FIXP

Mounting bracket type MBSET

For easy fixing of ancillary equipment

With these stainless steel (AISI 316) mounting brackets you easily fix cooling water strainers, no-smell and fuel filters on sound insulation materials up to 40 mm thick. They are supplied with bolts, washers and self-locking nuts. Fixings to mount the brackets are not included.

| Type | Description |
|---------|--|
| MBSET01 | Mounting bracket set M5 x 35 for ASD38V, ASD38H |
| MBSET02 | Mounting bracket set for ASDV/H, AIRVENTV/H |
| MBSET03 | Mounting bracket set for FTR140, WS180, WS720, NSFS |
| MBSET04 | Mounting bracket set for fuel filters 704, 709 & 712 |
| MBSET05 | Mounting bracket set for FTR330, FILTER150, NSF |



MBSET01

MBSET02

MBSET03

MBSET04

MBSET05

