

Prime Hog Solids Handling Self Priming Pump

Delivering sustainable wastewater pump solutions

Prime Hog X Series Pump



Prime Hog pump range includes:

Pump Size : 2" - 12"

Flow : up to 1,275 M3/hr (21,254 LPM)

Head : up to 43m

Solids Size: 3" (76.2mm)

The Prime Hog is a superior quality pump backed a 5 Year Warranty. Prime Hog pumps including parts are dimensionally equivalent & directly interchangeable with other popular brands on the market.

Prime Hog X Series complete range of spare parts includes:

- | | | |
|--------------------|--------------------------------|------------------------|
| ➤ Mechanical Seals | ➤ Impellers | ➤ Shafts |
| ➤ Wear Plates | ➤ Suction Check Valve Assembly | ➤ O-Rings & Gaskets |
| ➤ Seal Plates | ➤ Complete Rotating Assembly | ➤ Oil Seals & Bearings |

For pricing, availability, stocking requirements including technical queries, please contact BRANDON on 0468 959 646 or email brandon@wapsa.com.au for further assistance.

We invite you to contact us & discuss potential collaboration towards significant reduction of life cycle cost of your self priming pump & spare parts.

We look forward to hearing from you & servicing your self priming pump & parts requirements in moving forward.

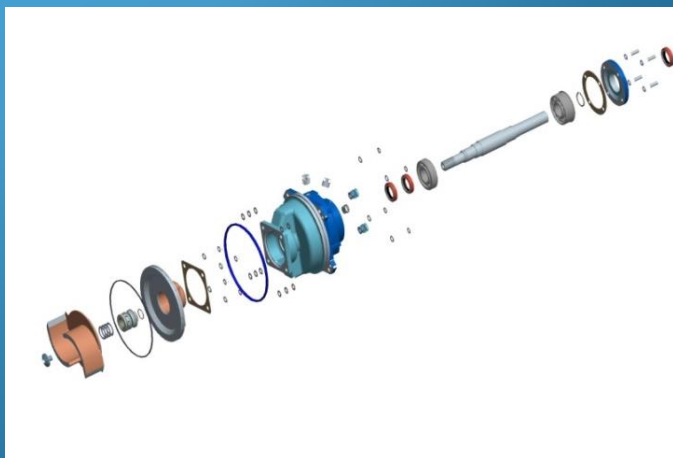

* contact WAPSA for further details including complete pump product range, features, availability &/or parts development queries. If you do not wish to receive any further marketing communication, please email info@wapsa.com.au to be removed from mailing list

Wastewater Aeration & Pump Systems Australia (WAPSA) Pty Ltd