

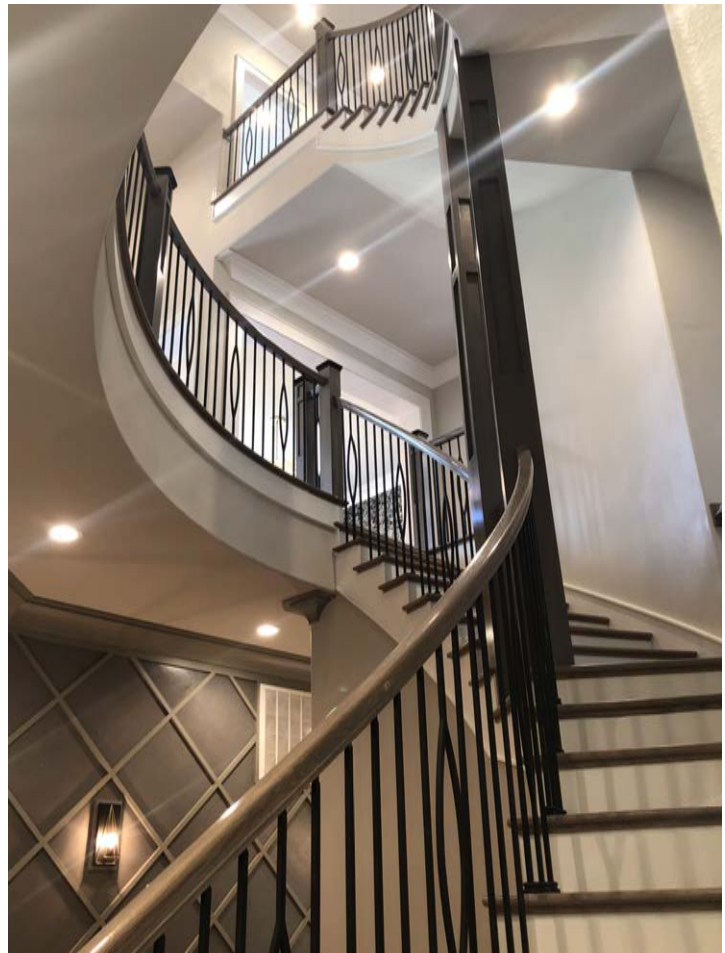

Up & Down Industries, Inc.

Stair Parts . Mouldings . Curved Moulding Kits . Doors  
Custom Woodworking . Since 1976  
2403 W. Hudson Rd, Suite 2 • Rogers, AR (479)925-1318

***Affordable Distinction Since 1976***





# TABLE OF CONTENTS

|                    |            |
|--------------------|------------|
| POWDER COATED      | 3-10       |
| Aalto              | 3-4        |
| Round              | 5          |
| Versatile          | 5          |
| A Y [ U            | 6          |
| G\c Y g            | 6          |
| : ]b]g\ Y g        | 6          |
| Tuscan             | 7-8        |
| Orleans            | 9          |
| Monte Carlo        | 9          |
| Gothic             | 9          |
| Twist              | 9          |
| <br>               |            |
| WOOD               | 12-18      |
| Handrail           | 12         |
| Newels & Balusters | 13-15      |
| Horizontal Rail    | 16         |
| Trim & Landing     | 17         |
| Treads             | 10&17      |
| Box Newels         | 13&15      |
| ADDITIONAL LINES   | Back Cover |

# Aalto Collection



Satin Black (shown)



Satin Black (shown)



Ash Grey (shown)



Ash Grey (shown)

# SIMPLY MODERN

## Aalto Collection



**ALL SHOWN:  
1/2" SQ  
HEIGHT: 44"  
TUBULAR**

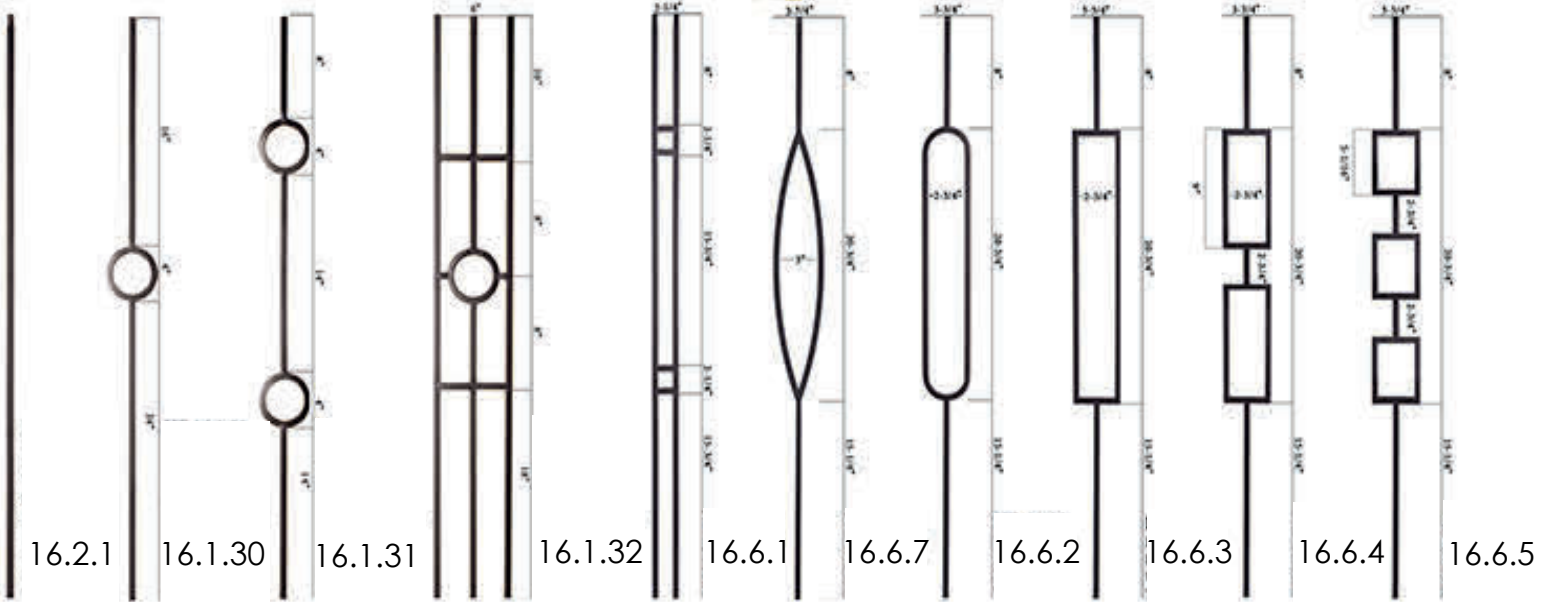

Rake panels fit all angles up to 40 degrees

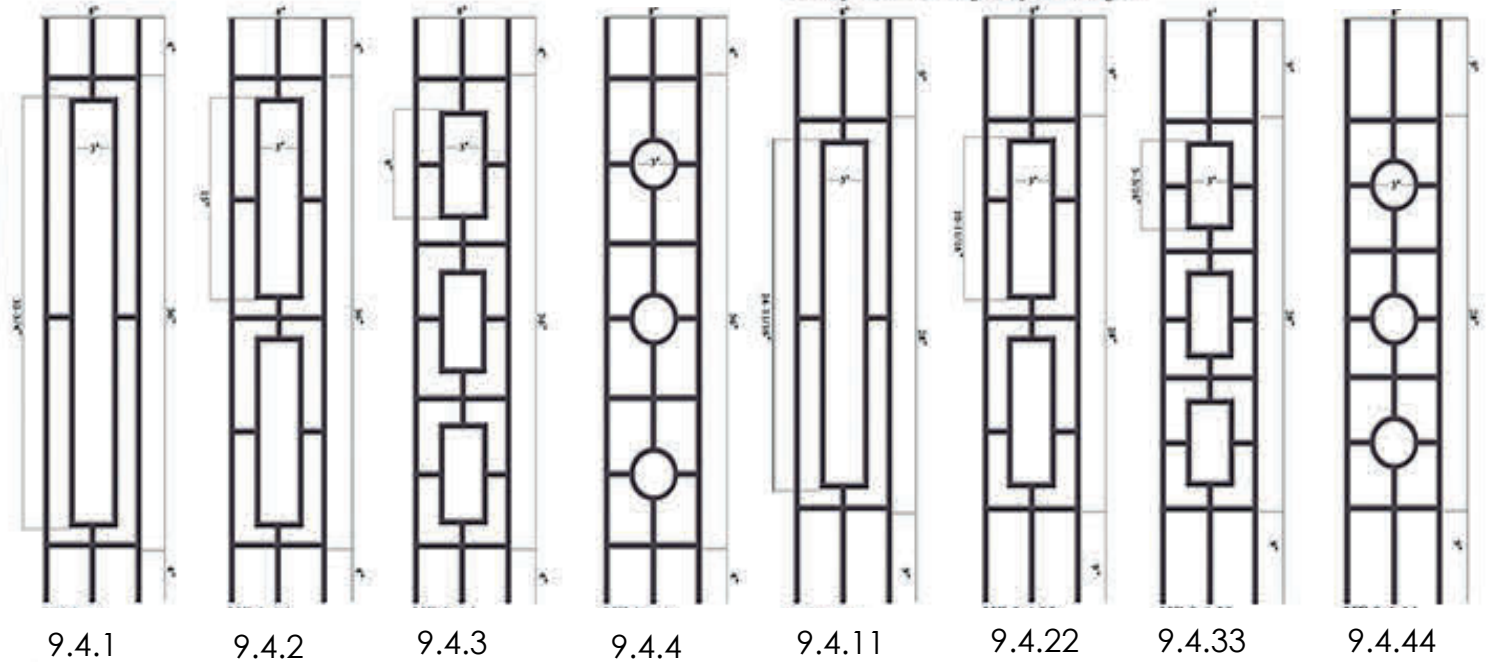

# ROUND



**HF 1.1.19**  
Ends: 9/16" Rd.  
Height: 48"  
Wt. 19 lbs.



**HF 2.8.18**  
Ends: 9/16" Rd.  
Height: 44"  
Wt. 3 lbs.

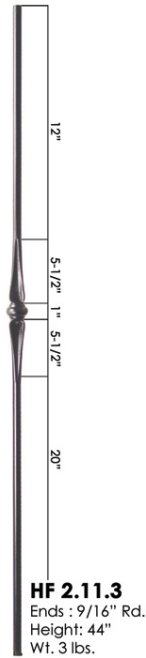

**HF 2.11.3**  
Ends: 9/16" Rd.  
Height: 44"  
Wt. 3 lbs.

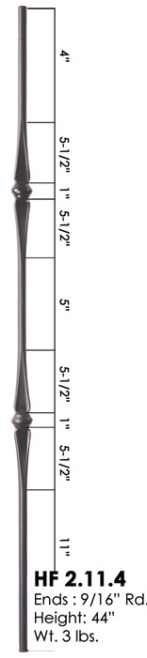

**HF 2.11.4**  
Ends: 9/16" Rd.  
Height: 44"  
Wt. 3 lbs.

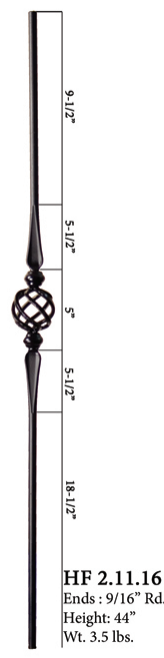

**HF 2.11.16**  
Ends: 9/16" Rd.  
Height: 44"  
Wt. 3.5 lbs.



**HF16.8.12**



**HF16.8.13**

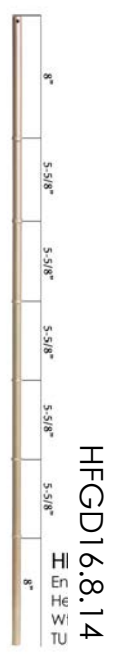

**HF GD16.8.14**  
HI  
EN  
HE  
WT

# VERSATILE

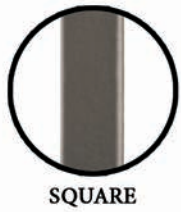

**HF 2.10.1**  
Ends: 1/2" Sq.  
Height: 44"  
Wt. 4.2 lbs.



**HF 2.2.3**  
Ends: 9/16" Sq.  
Height: 44"  
Wt. 3 lbs.



**HF 16.1.25**  
Ends: 1/2" Sq.  
Height: 44"  
Wt. 5.2 lbs.



**HF 16.1.25-S**  
Ends: 1/2" Sq.  
Height: 44"  
Wt. 5.2 lbs.



**HF 2.2.4**  
Ends: 9/16" Sq.  
Height: 44"  
Wt. 3.5 lbs.



**HF 16.5.8**  
Ends: 1-3/16" Sq.  
Height: 48"  
Wt. 19 lbs.



**HF 16.5.9**  
Ends: 1-3/16" Sq.  
Height: 48"  
Wt. 20 lbs.



**HF 16.2.1**  
Ends: 1/2" Sq.  
Height: 44"  
Wt. 3 lbs.



**HF 16.1.34**  
Ends: 1/2" Sq.  
Height: 44"  
Wt. 4 lbs.

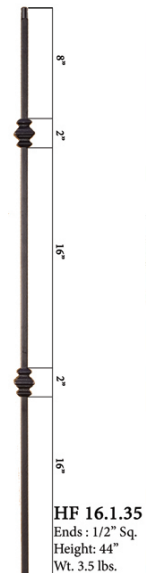

**HF 16.1.35**  
Ends: 1/2" Sq.  
Height: 44"  
Wt. 3.5 lbs.



**16.1.45-T Single Basket**  
1/2" Sq. x 44" tall  
1.6 lbs. - hollow iron

# MEGA



Pintop

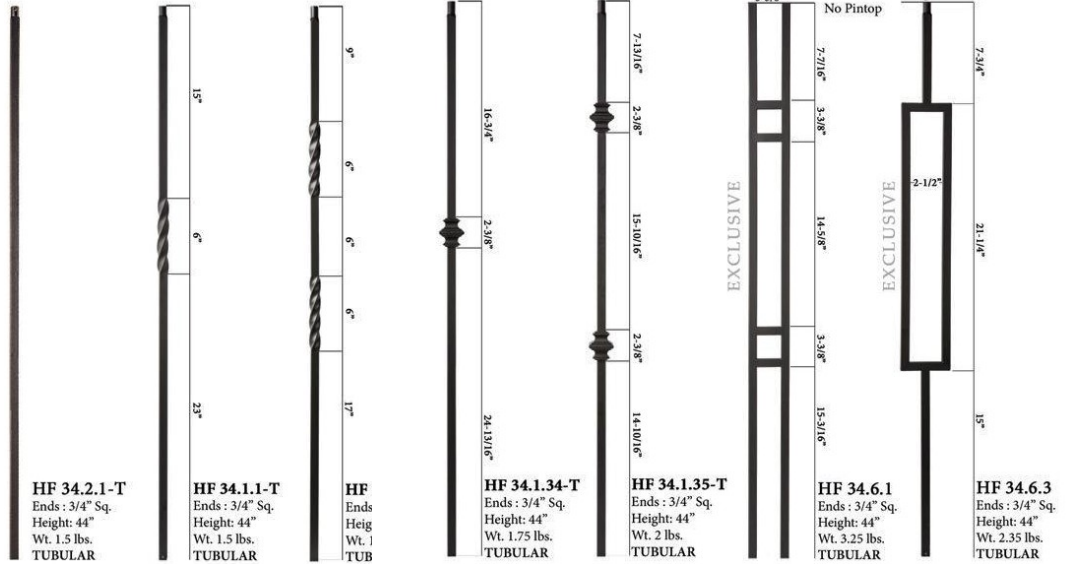

## Base Shoe/Collar Options

Available for round and square  
1/2", 9/16", 5/8", 3/4" Balusters



**HF34.3.16**  
 Level Base Collar - CAST IRON  
 Base : 2" Rd. - Height: 3/8" - Wt. .15 lbs.

## IRON FINISHES



\*Not all finishes available for each product

# TUSCAN



ROUND FORGED

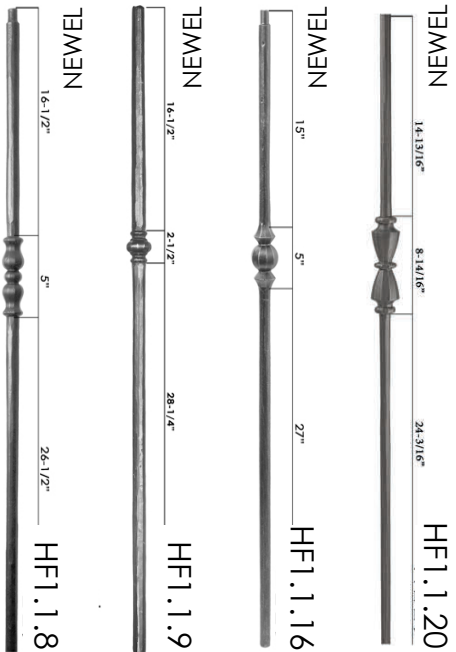
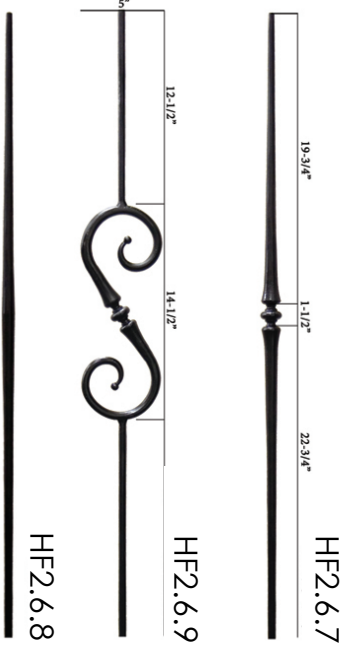
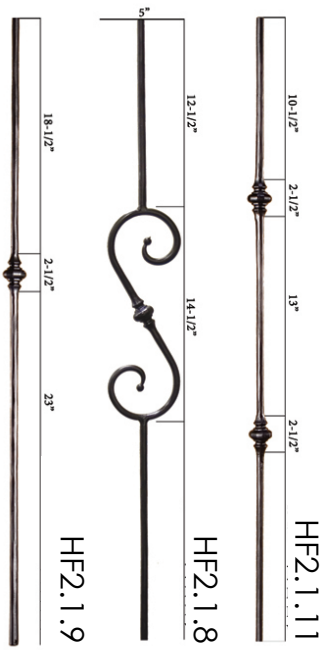
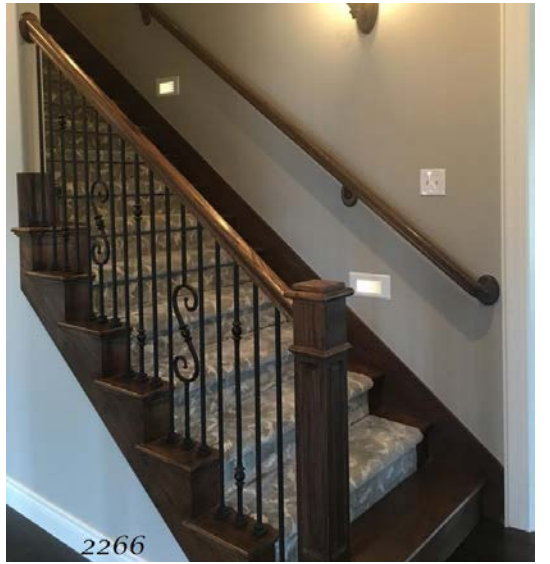



# TUSCAN



**SQUARE  
HAMMERED**



**HF 1.1.10**  
Ends : 1" Sq.  
Height: 47"  
Wt. 18 lbs.

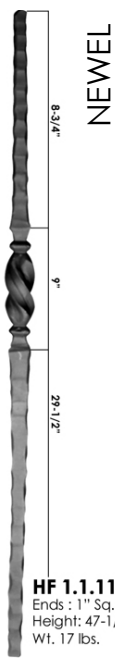

**HF 1.1.11**  
Ends : 1" Sq.  
Height: 47-1/4"  
Wt. 17 lbs.



**HF 1.1.14**  
Ends : 1" Sq.  
Height: 47"  
Wt. 18 lbs.



**HF 1.1.15**  
Ends : 1" Sq.  
Height: 47"  
Wt. 18 lbs.



**HF 2.9.12**  
Ends : 9/16" Sq.  
Height: 44"  
Wt. 3.8 lbs.



**HF 2.9.11**  
Ends : 9/16" Sq.  
Height: 44"  
Wt. 5 lbs.

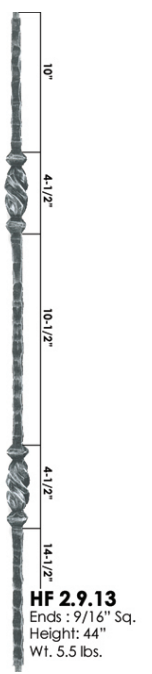

**HF 2.9.13**  
Ends : 9/16" Sq.  
Height: 44"  
Wt. 5.5 lbs.



**HF 2.9.3**  
Ends : 9/16" Sq..  
Height: 44"  
Wt. 3.4 lbs.



**HF 2.9.4**  
Ends : 9/16" Sq.  
Height: 44"  
Wt. 3.8 lbs.



**HF 2.9.5**  
Ends : 9/16" Sq..  
Height: 44"  
Wt. 3.5 lbs.



**HF 2.9.6**  
Ends : 9/16" Sq.  
Height: 44"  
Wt. 3.8 lbs.



**HF 2.1.2**  
Ends : 9/16" Sq.  
Height: 44"  
Wt. 4 lbs.



**HF 2.1.1**  
Ends : 9/16" Sq.  
Height: 44"  
Wt. 4.5 lbs.



**HF 2.9.20**  
Ends : 9/16" Sq.  
Height: 44"  
Wt. 4 lbs.



**HF 2.9.28**  
Ends : 9/16" Sq.  
Height: 44"  
Wt. 3.2 lbs.

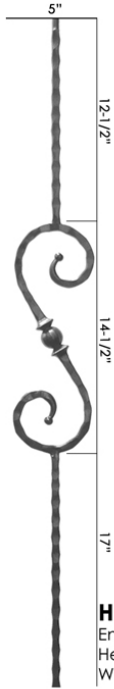

**HF 2.9.27**  
Ends : 9/16" Sq.  
Height: 44"  
Wt. 4.2 lbs.



**HF 2.9.26**  
Ends : 9/16" Sq.  
Height: 44"  
Wt. 3.8 lbs.



**HF 2.9.29**  
Ends : 9/16" Sq.  
Height: 44"  
Wt. 2.8 lbs.



**HF 2.9.36**  
Ends : 9/16" Sq.  
Height: 44"  
Wt. 4.2 lbs.



**HF 2.9.37**  
Ends : 9/16" Sq.  
Height: 44"  
Wt. 3.4 lbs.

# ORLEANS



SQUARE  
HAMMERED



**HF 1.1.14**  
Ends : 1" Sq.  
Height: 47"  
Wt. 18 lbs.



**HF 2.9.20**  
Ends : 9/16" Sq.  
Height: 44"  
Wt. 4 lbs.



**HF 2.9.23**  
Ends : 9/16" Sq.  
Height: 44"  
Wt. 3.5 lbs.



**HF 2.9.24**  
Ends : 9/16" Sq.  
Height: 44"  
Wt. 3.9 lbs.

# MONTE CARLO

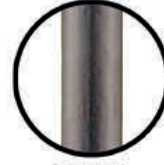

ROUND



**HF 18.2.1**  
Ends : 5/8" Rd.  
Height: 44"  
Wt. 5 lbs.



**HF 18.2.2**  
Ends : 5/8" Rd.  
Height: 44"  
Wt. 4 lbs.

# TWIST



SQUARE



**HF 16.5.4**  
Ends : 1-3/16" Sq.  
Height: 48"  
Wt. 18 lbs.



**HF 16.5.5**  
Ends : 1-3/16" Sq.  
Height: 48"  
Wt. 20 lbs.



**HF 16.1.1**  
Ends : 1/2" Sq.  
Height: 44"  
Wt. 3 lbs.



**HF 16.1.2**  
Ends : 1/2" Sq.  
Height: 44"  
Wt. 3 lbs.



**HF 16.1.3**  
Ends : 1/2" Sq.  
Height: 44"  
Wt. 4 lbs.



**HF 16.1.4**  
Ends : 1/2" Sq.  
Height: 44"  
Wt. 4 lbs.

# GOTHIC



SQUARE  
FACE HAMMERED



**HF 16.5.6**  
Ends : 1-3/16" Sq.  
Height: 48"  
Wt. 22 lbs.



**HF 16.1.7**  
Ends : 9/16" Sq.  
Height: 44"  
Wt. 4 lbs.



**HF 16.5.2**  
Ends : 9/16" Sq.  
Height: 44"  
Wt. 3.5 lbs.



**HF 16.1.8**  
Ends : 9/16" Sq.  
Height: 44"  
Wt. 3.8 lbs.



**HF 16.1.9**  
Ends : 9/16" Sq.  
Height: 44"  
Wt. 4.5 lbs.

# TREADS & END CAPS

\*Available in lengths of 42", 48", 54", 60", 72", or Custom.

\*Available in Red Oak, White Oak, Maple, or other species upon request

\*Available with traditional Bull Nose (as shown) and Modern Square nose

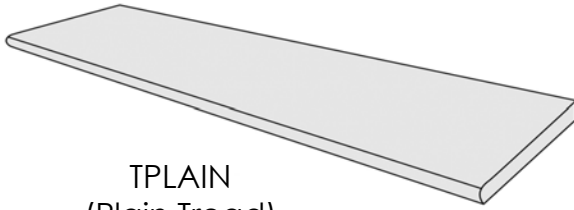

TPLAIN  
(Plain Tread)

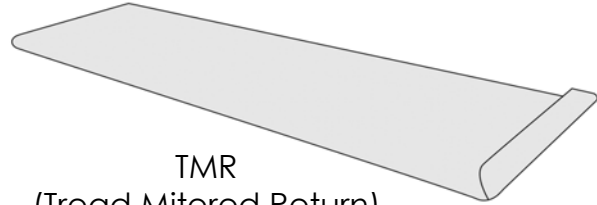

TMR  
(Tread Mitered Return)

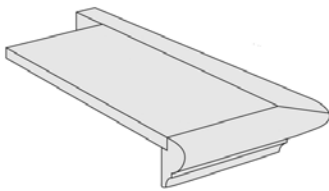

TLHMREC/TRHMREC  
(Left or Right Hand  
Mitered Return End Cap)

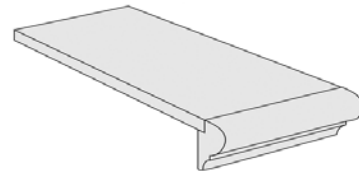

TWALLEC  
(Wall End Cap)





# HANDRAILS

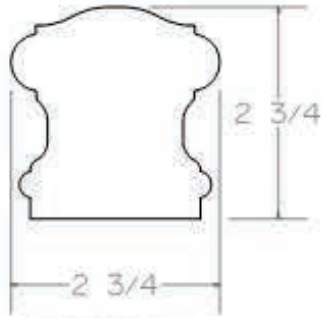

R7700

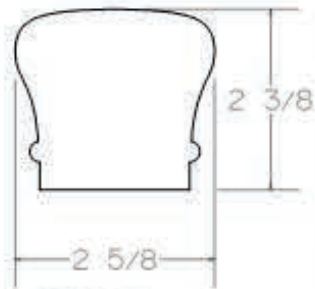

R6210

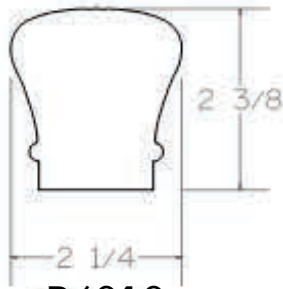

R6010

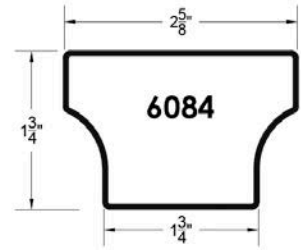

R6084

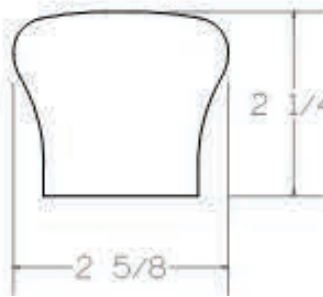

R6310

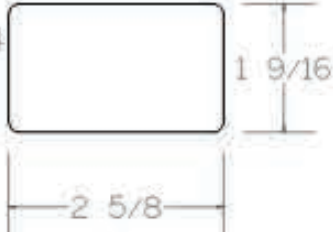

R6002

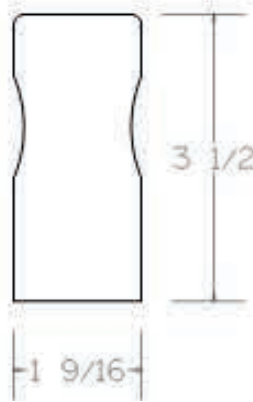

R6048

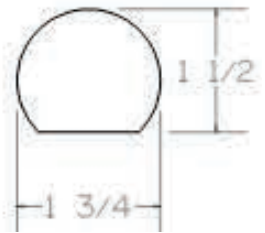

R6040



UDI 1188



1166  
UDI, Inc.

# Newel Posts

## Post to Post Systems Imported



|           |           |           |           |           |      |           |           |           |           |      |            |            |           |           |
|-----------|-----------|-----------|-----------|-----------|------|-----------|-----------|-----------|-----------|------|------------|------------|-----------|-----------|
| 4040/4042 | 4540/4542 | 4550/4555 | 4001/4002 | 4004/4005 | 4070 | 4240/4242 | 4074/4076 | 4840/4845 | 4172/4175 | 4179 | 4280/4280L | 4282/4282L | 4440/4442 | 3040/3042 |
| 4045/4046 | 4545/4546 | 4556      | 4003/4007 | 4008      |      | 4245      |           |           | 4176      |      | 4285       | 4287       | 4445/4448 | 3045/3046 |
| 4055      | 4547/4548 |           | 4008/4009 |           |      |           |           |           |           |      |            |            |           |           |

\*Most newels have a matching baluster. Contact the office for more details.

## Over the Post Systems



|           |      |      |           |      |           |      |           |      |           |           |           |           |      |           |
|-----------|------|------|-----------|------|-----------|------|-----------|------|-----------|-----------|-----------|-----------|------|-----------|
| 4010/4011 | 4014 | 4019 | 4030/4035 | 4065 | 4210/4215 | 4662 | 4810/4815 | 4862 | 4111/4115 | 4270/4275 | 4272/4277 | 4410/4415 | 4419 | 3015      |
| 4015/4017 |      |      |           |      |           |      |           |      |           |           |           |           |      | 3010/3011 |

## Box Newels Imported



|      |      |          |      |      |           |      |         |         |      |      |      |      |
|------|------|----------|------|------|-----------|------|---------|---------|------|------|------|------|
| 4075 | 4290 | 4291-ADJ | 4091 | 4077 | 4695/4691 | 4095 | 4891-FP | 4891-RP | 4090 | 4690 | 4790 | 4890 |
|------|------|----------|------|------|-----------|------|---------|---------|------|------|------|------|

\*Domestic options are available in a variety of species. Custom newels are also available. See our showroom for more details.







# WOOD BALUSTERS Domestic

1-1/4"









1-1/2"

1-3/4"

## 1-3/16" TURNED WOOD BALUSTERS

| 5015  | 5040<br>Tapered   | 5045  | 5141  | 5200   | 5205  | S4S   |
|---|---|---|---|--|---|---|
|          |  |        |  |     |  |  |
| *<br>5015-31<br>5015-34<br>5015-36<br>5015-39<br>5015-41<br>5015-43<br>option:<br>octagon | *<br>5040-31<br>5040-36<br>5040-39<br>5040-41<br>option:<br>octagon               | 5045-31<br>5045-34<br>5045-36<br>5045-39<br>5045-41<br>options:<br>fluted or<br>octagon | *<br>5141-31<br>5141-34<br>5141-36<br>5141-39<br>5141-41<br>option:<br>octagon    | *<br>5200-31<br>5200-34<br>5200-36/B<br>5200-39/B<br>5200-41/B<br>option:<br>octagon | 5205-31<br>5205-34<br>5205-36<br>5205-39<br>5205-41<br>option:<br>octagon           | *<br>1.25"<br>1.50"<br>1.75"  |

## 1-3/4" TURNED WOOD BALUSTERS

| 2005  | 2015  | 2318  | 5077  | 5300   | 5305  | 5545  | 3019  |
|---|---|---|---|--|---|---|---|
|                    |                    |  |  | *<br> |  |  |  |
| 2005-31<br>2005-34<br>2005-36<br>2005-39<br>2005-41<br>options:<br>fluted,<br>octagon,<br>twist, rope | 2015-31<br>2015-34<br>2015-36<br>2015-39<br>2015-41<br>options:<br>fluted,<br>octagon,<br>twist, rope | 2318-36<br>2318-41<br>options:<br>fluted or<br>octagon                              | 5077-31<br>5077-36<br>5077-39<br>5077-41  | 5300-31<br>5300-34<br>5300-36/B<br>5300-39/B<br>5300-41/B<br>option:<br>octagon          | 5305-31<br>5305-36<br>5305-39<br>5305-41<br>option:<br>octagon                        | 5545-34<br>5545-36<br>5545-39<br>5545-41<br>options:<br>fluted or<br>octagon          | 3019-36<br>3019-39<br>3019-41<br>option:<br>fluted                                    |

Available in all stain grade wood species

\*available primed

# BOX NEWELS Domestic

-Available in Red Oak, White Oak, Maple, & Poplar

## Plain Series

Available in 4 1/2", 6", and 7 1/2"

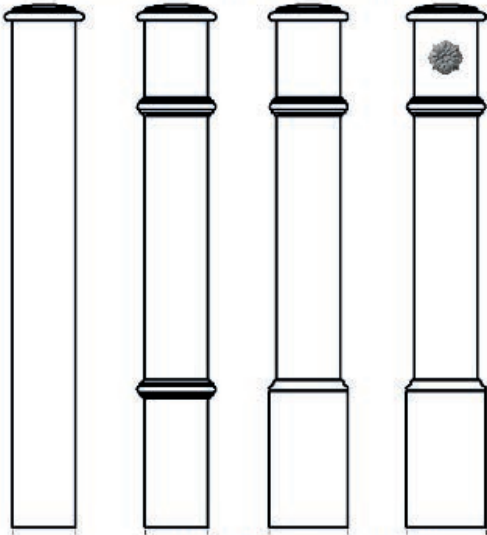

With Trim\*

With Trim, Step Out and Iron Medallions\*

## Mission Series

Available in 4 1/2" and 6"

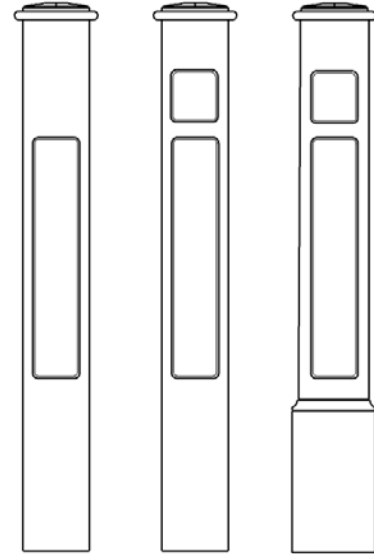

With 131 Trim and Step Out\*

## Routed Panel Series

Available in 4 1/2" and 6"

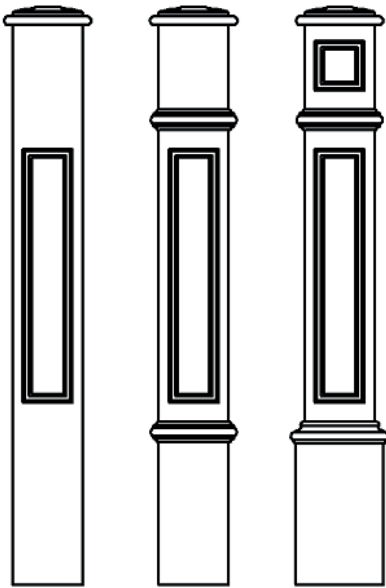

With Trim\*

With 816 Trim and Step Out\*

\*Step Out and Trim are sent unattached to box newel to be assembled on-site.

## Flat Panel Box Newel

Imported

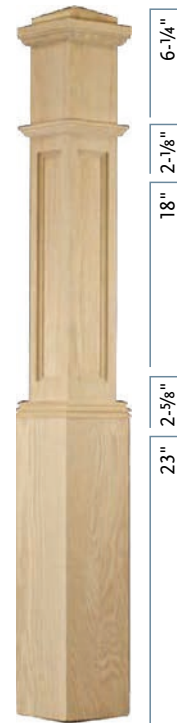

52"

C-4091-FP  
Flat Panel  
Base Width 6-1/4"

\*RO, POP, and PR do not include EZ Mount Block

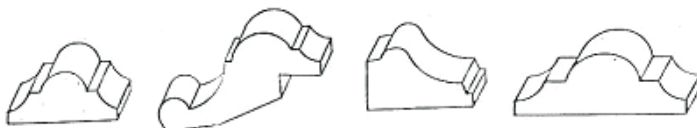

#134  
1/2 x 1"  
Used with 4"  
Box Newel

#816  
13/16 x 2"  
Step Out Trim

#131  
3/4 x 1 1/6"  
Step Out Trim

#133  
11/16 x 1 3/4"  
Used with 6"  
Box Newel



# HORIZONTAL RAILING SYSTEM

- This modern look made easy, 2 ways
  - Material only kits, for field installation
  - Turn-key, with installation provided

## Materials Includes:

### Stainless Steel Cable Rail Kits

-For level and/or rake with iron and/or wood newels

- 1x19 Stainless Steel cable
- Pre-attached swaging stud / Hanger Bolt / Pre-attached threaded stud
- Pull-Lock fitting with cap / Push-Lock Lag / Push-Lock threaded eye
- Stainless Steel washers / Beveled washers / SC-6 Screws / brass locknut
- Invisiware Receiver / Pre-attached swaging ferrule

### Horizontal Bars - Powder Coated

-For level and/or rake with iron and/or wood newels



\*For use with powder-coated, stainless, and wood newels

## UDI Installed Horizontal Railing System:

Patented newels with internal locking for a concealed, clean look. No exposed welds



# TRIM, ROSETTES, and LANDING TREAD

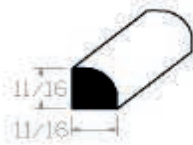

Base Shoe Trim  
TRIM BASE SHOE

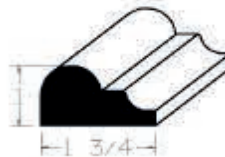

End Cap Nosing  
TECNOSINGOAK  
TECNOSINGMAPLE

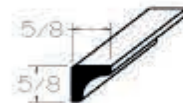

5/8" Cove Trim  
TRIM COVE OAK  
TRIM COVE MAPLE

Fillet 1 3/4"W x 7/16"H  
-R6007 OAK  
R6007 MAPLE

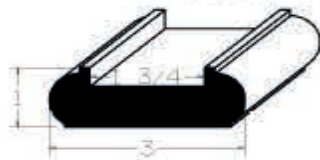
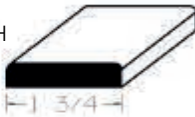

Shoerail 3"W x 1"H (1 3/4" Plow)  
- R6006OAK  
- R6006MAPLE



Fillet 1 1/4"W x 5/16"H  
- R6050 OAK  
- R6050 MAPLE

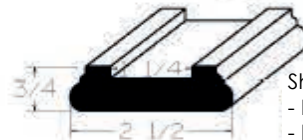

Shoerail 2 1/2"W x 3/4"H (1 1/4" Plow)  
- R6045 OAK  
- R6045 MAPLE

Square Nose Landing Tread  
• R8086

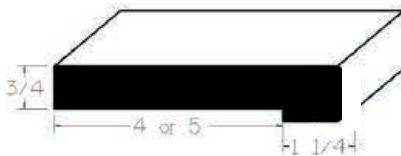

3/8" x 1 1/4" TRIM  
TRIM 1 1/4" OAK  
TRIM 1 1/4" MAPLE

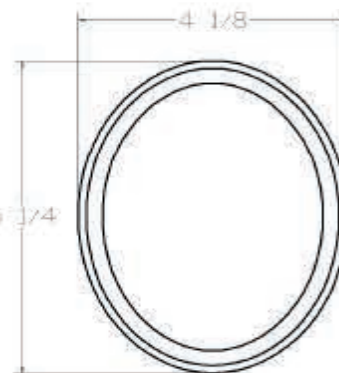

**Rosette Oval**

- M7037  
- Oval Backer 1" thick to allow greater hand room from wall

**Rosette Round**

- M7017

**Rosette Rectangle**

- M7095

Bull Nose Landing Tread

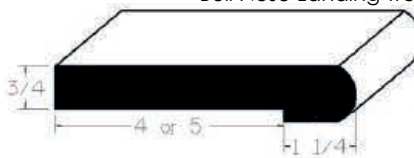

Oak, Ambrosia and Maple Landing Tread

- R8085 Oak
- R8085 Maple
- R8085 Amrosia

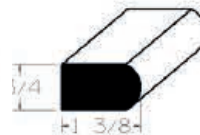

2 Side Round Over  
• RO2SC1 3/8"

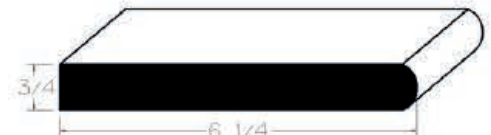

2 Side Round Over

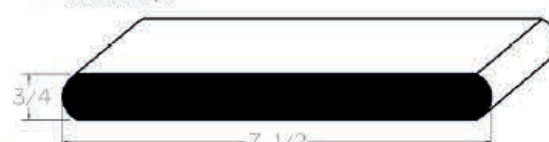
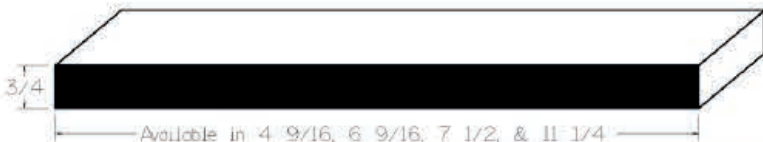

4 Side Round Over  
• RO4SC7.5"

## Hardware and Tools Available:

- Lag Bolt (M LAG BOLT)
- Rail Bolt Kit (M RAIL BOLT)
- Dowel Screw (M DOWEL SCREW)
- Suretite Newel Fastener (M SURETITE)\*\*\*
- Wall Handrail Brackets available in Satin Black (STB), Bright Brass (BB), Oil Rubbed Bronze(ORB), Brushed Nickel (NIC)(M WALL BKET- "FINISH")
- Dowel Screw Driver (T DOWEL DRIVER)
- Newel Post Fastener (M L\_BRACKET) \*\*\*
- Baluster Drill Guide (T DRILL GUIDE)
- Rail Bolt Driver (T RAIL BOLT DR)
- Rail Bolt Wrench (T WRENCH)

\*\*\* (Not recommended as ideal way to secure newels. Ideally newels should be dropped into or lapped over the floor.)



2923



2116



2268

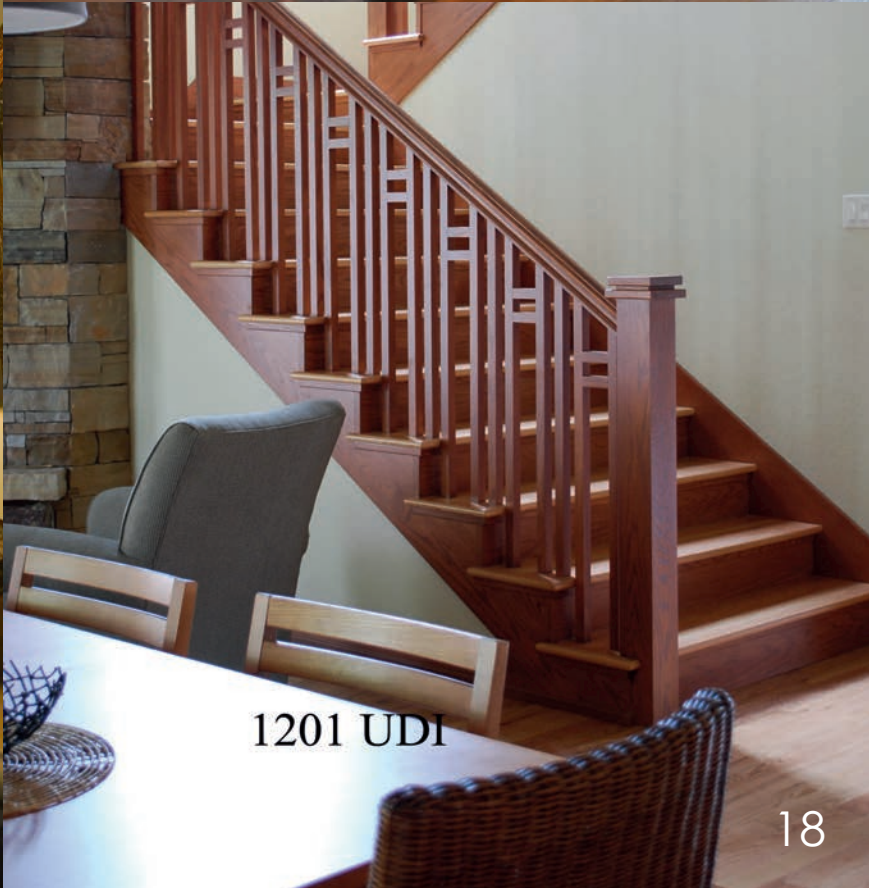

1201 UDI



Grand Opening  
Arched Casing Systems  
Curved Casing



Moulding



Iron Doors



Interior Doors



Entry Doors



Specialty Millworks

# Additional Product Lines

2403 W Hudson Rd. Suite 2 Rogers, AR 72756  
(479)925-1318