



strong. durable. stylish.

Model 8700 is engineered to provide a maintenance free and elegant look that will last a lifetime.

These doors won't rust, fade, crack or dent. It is the ultimate door for easy-care living.



Model 8700 Colonial Panel, Glacier White finish, Ruston windows

PERFORMANCE FEATURES

- This door has full PVC color construction. This means scratches are less visible because the color goes all the way through the material.
- The UV-Resin used in the door's construction contains special polymers that protect the door sections from the sun's harmful ultraviolet rays.
- Tamper-resistant safety bottom brackets help avoid possible injury by preventing inadvertent loosening while the counterbalance cables are still under tension.
- The Wayne Dalton TorqueMaster® Plus is our exclusive counterbalance system that safely and cleanly contains the springs inside a steel tube. TorqueMaster Plus® features anti-drop safety technology.
- Recommended for coastal regions for its resistance to salt air and sand.

Wayne Dalton Windsafe doors have wind load-rated reinforcements to comply with various approval agencies, including Florida Building Code, TDI (Texas Department of Insurance, and Miami-Dade County (FL).



1 Choose Your Style

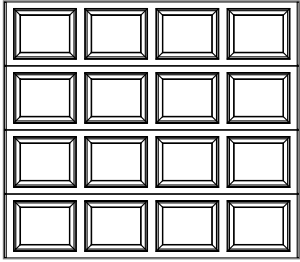

Colonial

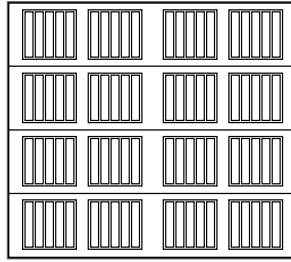

Sonoma

2 Choose Your Color



Glacier White



Adobe Cream



Monterey Sand



Cape Cod Gray

Actual door colors may vary slightly from the brochure due to fluctuations the printing process. Always request a color sample from your Wayne Dalton Dealer for accurate color matching.

3 Choose Your Windows

Optional insulated glass available for improved thermal performance.



Cathedral I



Ruston



Stockton I



Williamsburg I

Etched privacy glass (only available on insulated glass)



Diamond



Eclipse



Prairie

- ① R-11.75* polyurethane insulation is permanently bonded to the vinyl skin for thermal efficiency, durability and added rigidity.

- ② Twin 20-gauge steel C-channels run full length of each panel and are anchored to interior steel stiles for strength.

*Wayne Dalton uses a calculated door section R-value for our insulated doors.

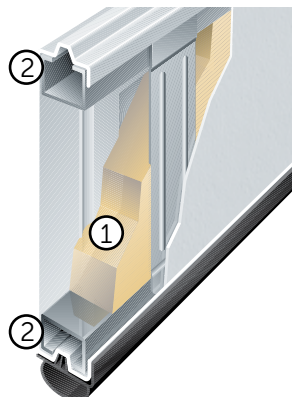

Wayne Dalton warrants this door for 15 years against peeling, flaking, chipping or cracking of the vinyl skin and 5 years against excessive color fading of the vinyl skin. See the warranty certificate for more details.

AFTER

BEFORE

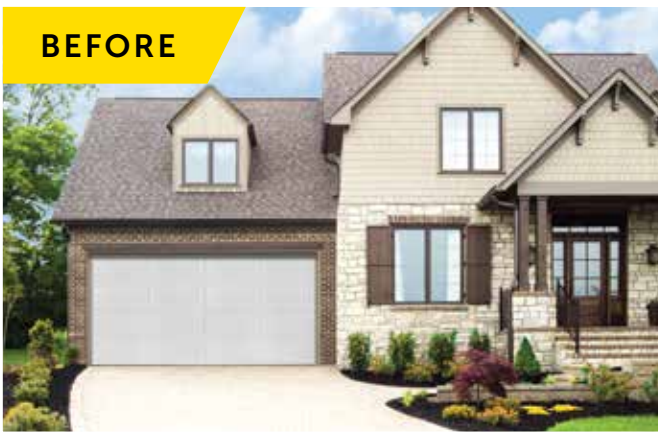

Model 8700 Sonoma panel, Monterey Sand with Stockton I windows



Garage Door Design Center

Go to **wayne-dalton.com** today and click on Design Center. Here you can upload a photo of your home and experiment with panel designs, color options, window styles and hardware designs. Instant curb appeal awaits with just the click of your mouse!

Wayne Dalton
GARAGE DOORS™

DISTRIBUTED BY:

2501 S. State Hwy 121 Bus., Ste 200
Lewisville, TX 75067

wayne-dalton.com



© 2016 Wayne Dalton, a Division of Overhead Door Corporation. Consistent with our policy of continuing product improvement, we reserve the right to change product specifications without notice or obligation. Item 343879 11/2016