

Saddleback

AZUSA BUSINESS CENTER

Another Quality Development By:

RRK Properties

Shaw Industrial Property

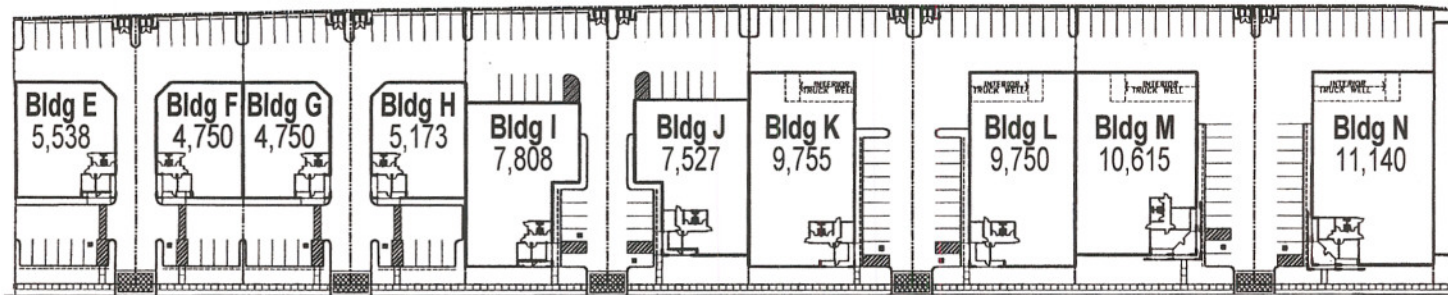

TODD AVENUE

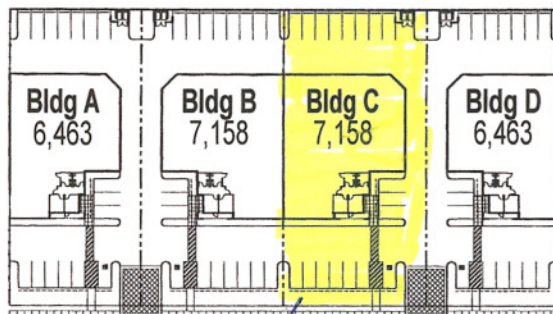

FOOTHILL BOULEVARD

1311 W. Foothill Blvd

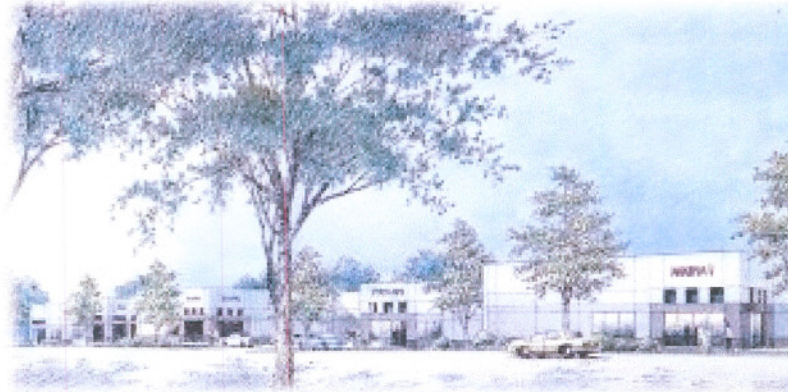

Features

Master Planned Business Park
 State-of-the-Art Warehouse/Distribution/
 Light Manufacturing Buildings
 Located Near the Interchange of the San Gabriel
 (605) Freeway, and Foothill (210) Freeway
 Direct (210) Freeway Access
 High Ceiling Clearances

Fenceable Private Yards
 Foil Insulated Ceilings with Sky Lights
 Calculated Fire Sprinklers on Buildings
 Highly Accessible to Los Angeles, San
 Inland Empire and Orange County Markets
 No Development Bonds